

Southern Association for Institutional Research

October 16-19, 2004



**The Bayview Resort and Spa
of the Grand Casino
Biloxi, Mississippi**

2004 Conference Program

**SAIR BOARD OF DIRECTORS
2003-2004**

President

Jim Purcell
Oklahoma State Regents for Higher Education

Vice President

Ross A. Griffith
Wake Forest University

Secretary

Teresa P. Hall
University of Alabama at Birmingham

Treasurer

Michelle Hall
Southeastern Louisiana University

Past President

J. Joseph Hoey
Georgia Institute of Technology

Members At Large

Marcus S. Babaoye
Worcester State College

Denise Gardner
Georgia Institute of Technology

Lorne Kuffel
The College of William and Mary

Christine Mee
Coastal Carolina University

SAIR/Institute of Higher Education Liaison

Larry G. Jones
University of Georgia

Southern AIR
Jim Eck, *Rollins College*, Editor

CONFERENCE AT A GLANCE

Saturday, October 16

7:30am - 5:00pm Registration (Convention Center Lobby)
8:00am Shuttle departs for workshops on Jefferson Davis Campus
8:00am - Noon Workshops
8:30am - Noon SAIR Board Meeting (Bay 2)
12:30pm and 1:00pm Shuttle departs for workshops on Jefferson Davis Campus
1:00pm - 5:00pm Workshops
1:00pm - 5:00pm Southern University Group (Bay 7/8)
6:00pm - 7:00pm Reception for early arrivals (President Purcell's suite)
7:00pm - 9:00pm Dinner out for early arrivals

Sunday, October 17

7:30am - 5:00pm Registration (Convention Center Lobby)
7:30am and 8:00am Shuttle departs for workshops on Jefferson Davis Campus
8:00am Shuttle departs for the Charlie Brown Mixed Doubles Tennis Tournament
8:00am - Noon Workshops
8:30am - Noon Southern University Group (Bay 7/8)
12:30pm Shuttle departs for workshops on Jefferson Davis Campus
1:00pm - 4:00pm Workshops
4:00pm - 4:45pm Presenters & Facilitators Meeting (Bay 8)
4:00pm - 4:45pm Vendors Meeting (Bay 2)
5:00pm - 5:45pm Newcomers' Reception (Ballroom C)
6:00pm - 7:30pm Conference Opening Session (Ballroom A/D)
7:30pm - 9:30pm Opening Reception (Poolside)

Monday, October 18

7:30am - 5:00pm Registration (Convention Center Lobby)
7:30am - 8:15am Continental Breakfast (Convention Center Lobby)
7:30am - 8:15am Dinosaurs' (Past Presidents) Breakfast (Pascagoula)
7:30am - 8:15am Affiliated & Special Interest Groups
8:30am - 9:45am Conference General Session (Ballroom A/D)
10:00am - 10:45am Concurrent Sessions
11:00am - 11:45am Concurrent Sessions
Noon - 1:00pm Luncheon Roundtables (Ballroom B/C)
1:15pm - 2:00pm Concurrent Sessions
2:15pm - 3:00pm Concurrent Sessions
3:00pm - 3:30pm Refreshment Break with Vendors (Convention Center Lobby)
3:30pm - 4:15pm Concurrent Sessions
4:30pm - 5:15pm Affiliated & Special Interest Groups
6:00pm - 11:00pm Special Event "Sunset Cruise and Dinner Dance" (Meet in Convention Center lobby at 5:45pm)

Tuesday, October 19

7:30am - 9:00am Awards Breakfast & SAIR Annual Business Meeting (Ballroom B/C)
9:15am - 10:00am Concurrent Sessions
10:15am - 11:00am Concurrent Sessions
11:15am - Noon Concurrent Sessions
12:15pm - 3:00pm SAIR Board Meeting (D'Iberville)

Welcome to SAIR 2004

Welcome to Biloxi, Mississippi and the 31st SAIR 2004 conference. The conference planning committees and members of the Mississippi Association for Institutional Research (MAIR) have planned a multitude of professional development opportunities for us.

Our conference theme is “**Interaction, Inspiration, Research and Planning**” while SAIR is celebrating the organization’s 30th birthday. The conference track of “*Planning*” has been added this year to the traditional tracks of *Accreditation*, *Assessment*, *Community College*, *Institutional Research* and *Technology*. There are a variety of workshops, concurrent sessions and luncheon roundtable sessions as choices on all six conference tracks.

After the opening general session on Sunday evening, a pool-side reception will feature local cuisine with special music. The **Special Event** on Monday evening will begin with a one hour sunset cruise on the Gulf followed by a buffet dinner, birthday cake and three hours of dancing at the Bayview Resort.

We are also most appreciative of our vendors and sponsors for their support. Please plan to visit the exhibit booths throughout the conference but particularly during the opening reception on Sunday evening and the refreshment break on Monday afternoon.

Finally, thanks to each and every one of you for your attendance which will carry the momentum of SAIR’s success into our fourth decade.

Ross A. Griffith
SAIR 2004 Program Chair

Conference Tracks

The **Accreditation Track** sets the framework for preparing for SACS self study and discusses why Institutional Research and Assessment are absolutely essential to the new criteria, concentrating on what we can do as researchers to better facilitate the accreditation process.

The **Assessment Track** will discuss appropriate and effective assessment tools, the utilization of national surveys, value added research, and the benefits of graduate assessment.

The **Community College Track** will emphasize the diverse nature of problems faced by community colleges, and develop a plan of attack that is appropriate for the unique needs of two-year institutions.

The **Institutional Research Track** welcomes newcomers to Institutional Research and Assessment while focusing on integration of their programs into the academic matrix within which all higher education professionals must work.

The **Planning Track** will include a focus on how assessment and institutional research support successful planning efforts. Strategic Planning is vital to the financial health of our institutions as well as accomplishing our missions.

The **Technology Track** looks at where Institutional Research and Assessment are heading in the face of rapid technological change and will address issues such as web programming, software applications, security, and efficient information dispersal.

Conference Awards

Please leave copies of recent work at the registration desk no later than 1:00pm on Monday, October 18, for various awards which will be given at the Awards Breakfast. The awards are the following: Best Fact Book, Best Planning Document, Best Mini Fact Book, and Best Web Site and Electronic Fact Book.

SATURDAY, OCTOBER 16

Saturday, October 16, 7:30am—5:00pm

REGISTRATION

Location: Bayview Convention Center Lobby

Saturday, October 16, 8:30am—Noon

SAIR Board MeetingConvener: Jim Purcell, *Oklahoma State Regents for Higher Education*

Location: Bay 2

WORKSHOPSSaturday, October 16, 8:00—11:30am
WORKSHOPS**Workshop 1: Beginning SPSS for the Institutional Researcher**

Saturday, October 16, 8:30 - 11:30am

Location: Jefferson Davis Campus of MGCCC (shuttle from hotel lobby, 8:00am), Building "X"

Presenter: Paul Illich, *McLennan Community College*

This hands-on three-hour session will highlight the capabilities of the statistical research tool, SPSS 12.0. Through a series of step-by-step exercises, participants will learn a variety of practical tactics and procedures for utilizing typical institutional data including reading data into SPSS, labeling variables and values, modifying and selecting data for computations, manipulating file structures, creating and interpreting a variety of statistical procedures, and preparing and printing reports. Participants will become familiar with the primary features of SPSS and will be introduced to the programming language for SPSS (Syntax) that can be used to automate report production. Direct experience with SPSS and/or analytical/inferential statistics is NOT necessary.

Workshop 2: HTML for Designing Web Pages

Saturday, October 16, 8:30 - 11:30am

Location: Jefferson Davis Campus of MGCCC (shuttle from hotel lobby, 8:00am), Building "X"

Presenter: Jacob Jasin, *Southeastern Louisiana University*

This workshop is designed for participants who have an interest in designing web pages, but have only a basic knowledge or no knowledge of HTML. Participants will receive step-by-step instructions and hands-on practice using HTML tags to design web pages. Participants will master basic HTML tags and be able to create hyperlinks, tables, frames and forms; as well as learn how to write and embed JavaScript and Cascading Style Sheets for creative web pages.

Workshop 3: The Principles of Accreditation and Training the Evaluator

Saturday, October 16, 8:00 - 11:30am

Location: Bay Resort/Convention Center, Bay 5

Presenter: Ann B. Chard, *Commission on Colleges of the Southern Association of Colleges and Schools*

The first part of this workshop will be an overview of the *Principles of Accreditation* with particular attention to institutional effectiveness and research. This session will include a discussion of the philosophical differences in requirements between the former *Criteria* and the new *Principles*. The second part of the workshop will provide official training for evaluators serving on visiting committees, particularly the Off-Site and On-Site Committees involved in the reaffirmation process.

Workshop 4: Organizational Models and Assessment

Saturday, October 16, 8:30 - 11:30am

Location: Bay Resort/Convention Center, Bay 4

Presenter: John Harris, *Samford University*

Assessment of results adds its greatest value when it serves as a feedback loop in horizontal, flow-through systems. Yet, colleges and universities are usually organized as bureaucracies of disciplinary and functional silos. Curricula are usually collections of modular courses rather than integrated systems designed to produce certain learning outcomes. First, horizontal organization and organic systems will be contrasted with the conventional silo organization. Then, participants will "imagineer" and graphically depict institutions or curricula as horizontal organizations or organic systems (starting with the destinations and back-mapping to organization and curricular design).

Saturday, October 16, 1:00—5:00pm

SOUTHERN UNIVERSITY GROUP (SUG)Convener: Sam Lowther, *Auburn University*

Location: Bay 7/8

**Saturday, October 16, 1:00—5:00pm
WORKSHOPS**

Workshop 5: Applied Statistics Using SPSS

Saturday, October 16, 1:00 - 4:00pm

Location: Jefferson Davis Campus of MGCCC (shuttle from hotel lobby, 12:30pm), Building “X”

Presenter: Paul Illich, *McLennan Community College*

This workshop will focus on the application of descriptive and inferential statistics. The first part will cover the following concepts: quantitative vs. qualitative data, level of measurement, representative samples, statistical power, descriptive statistics, inferential statistics, non-parametric versus parametric statistics, confidence intervals, and statistical significance. The second part of the workshop will involve hands-on exercises using SPSS to perform a variety of statistical procedures (e.g., Crosstabulation, Chi-Square, correlation, regression, ANOVA, and others). Participants will learn when and how to perform a given procedure, and how to interpret the results produced by SPSS for each procedure. No previous statistical experience is required.

Workshop 6: Microsoft Access for Beginners

Saturday, October 16, 1:30 - 4:30pm

Location: Jefferson Davis Campus of MGCCC (shuttle from hotel lobby, 1:00pm), Building “X”

Presenter: Vinay Ramachandra, *Southeastern Louisiana University*

Many Institutional Research offices use either SAS or SPSS for data analysis and reporting. These programs are extremely powerful, but for certain types of analysis and reporting, Microsoft Access may be a more viable alternative. This is especially true for report generation. Using Access one can create complex reports quickly and without much effort. This workshop aims at providing the attendees hands-on experience with MS Access 2000 and is intended for audiences with little or no experience with Access, but who have some familiarity with relational database concepts. The participants will learn how to import/export data into/from Access and learn the use of the query tool to run various types of queries. In addition, they will learn how to generate reports and build expressions using the expression builder.

Workshop 7: A Beginner's How-To Guide to the Profession: A Skills-Building Workshop for New Institutional Researchers

Saturday, October 16, 1:00 - 5:00pm and Sunday 8:00 am – Noon

Location: Jefferson Davis Campus of MGCCC (shuttle from hotel lobby at 12:30pm on Saturday and 7:30am on Sunday), Building “B”

Primary Presenter: Karen Bauer, *University of Georgia*

Additional Presenter: Larry Jones, *University of Georgia*

This workshop is designed for practitioners who are new to the field of institutional research. With a combination of facilitator

lecture/discussion and hands-on exercises at desktop computers, this workshop will address such key components as identifying sources of data, developing fact books and peer comparisons, survey research for assessment and evaluation, and how to complete an effective report or presentation. The main focus of the workshop is a presentation of general concepts and practical strategies for the implementation or continued development of effective institutional research at many colleges and universities, regardless of size or type.

Workshop 8: IPEDS: Data Cutting Tool and On-line Tutorial

Saturday, October 16, 1:30 - 4:30pm

Location: Jefferson Davis Campus of MGCCC (shuttle from hotel lobby 1:00 pm), Building “X”

Co-Presenters: Cel Johnson, *University of San Diego*
Darline Morris, *Texas State Technical College*

Electronic IPEDS reporting has allowed for a flexible and ever-evolving program. The National Center for Education Statistics (NCES) has answered the challenge by improving access to the data and tools needed to navigate the Peer Analysis System. This workshop will introduce the latest changes and participants will have the opportunity to practice hands-on exercises. In addition, there will a demonstration of the Dataset Cutting Tool that allows users to customize data files and download entire IPEDS data tables.

Workshop 9: Using Surveys to Assess Outcomes

Saturday, October 16, 1:00 - 4:00pm

Location: Bay Resort/Convention Center, Bay 5

Presenter: Marilyn J. Greer, *The University of Texas M. D. Anderson Cancer Center*

The topics in this workshop start from the initial ideas required to generate a research objective and study a hypothesis through the complete design, analysis and reporting of the survey. Sample size, response rates, and data entry will also be covered, all with explicit examples. Instruction on conducting focus groups will also be included in the workshop. A comprehensive workbook (including appendices of several different surveys and reference material) will be furnished for all participants.

**Saturday, October 16, 6:00—7:00pm
RECEPTION FOR EARLY ARRIVALS
President Purcell's suite**

Early Arrivals and Newcomers meet in hotel lobby for transportation to dinner — 7:00pm.

SUNDAY, OCTOBER 17

Sunday, October 17, 7:30am—5:00pm

REGISTRATION

Location: Bayview Convention Center Lobby

Sunday, October 17, 8:00am—Noon and 1:00—4:00pm
WORKSHOPS

Sunday, October 17, 8:00am—Noon
CHARLIE BROWN MIXED DOUBLES
TENNIS TOURNAMENT

Participants meet in the hotel lobby at 8:00 to ride shuttle to courts at Jefferson Davis campus.

Sunday, October 17, 8:30am—Noon
SOUTHERN UNIVERSITY GROUP (SUG)

Convener: Sam Lowther, *Auburn University*
Location: Bay 7/8

Workshop 10: Enhancing Your SAS Programming Skills with PROC SQL and SAS Macros

Sunday, October 17, 8:30 - 11:30am

Location: Jefferson Davis Campus of MGCCC (shuttle from hotel lobby, 8:00am), Building “X”

Presenter: Kathleen Morley, *Baylor University*

This workshop will provide hands-on instruction and practice using the macro facility and PROC SQL from SAS. The SAS macro facility enables the programmer to reduce the amount of text required to accomplish the task at hand, allowing for programs to be reused and thus to be more efficient. Instruction will cover both macro variables and macro programs. PROC SQL provides the user with the ability to use the structured query language (SQL) within the SAS System. This procedure can replace the need for multiple DATA and PROC steps with one query. The workshop will teach the user how to perform basic queries and simple joins and to create tables. Participants should have experience in using the SAS libname, data step, and other basic SAS functions. Participants will be provided with a CD containing sample data sets, programs, and a list of recommended references.

Workshop 11: SACS Compliance Certification

Sunday, October 17, 8:30 - 11:30am

Location: Jefferson Davis Campus of MGCCC (shuttle from hotel lobby, 8:00am), Building “X”

Primary Presenter: Sharon M. Carrier, *Rollins College*

Additional Presenters: Jim C. Eck, *Rollins College*; Udeth Lugo, *Rollins College*

This workshop on “Creating Viable Integrated Systems for Institutional Assessment and Compliance Certification for Reaf-

firmation of Accreditation” will show participants how to create viable integrated systems for both ongoing institutional assessment and SACS’ new Compliance Certification process. Participants will learn how institutional strategic planning and accreditation requirements led one college to establish these functional systems and what specific steps to take to develop similar systems. The presenters will share procedures, structures, timelines, activities, and technological tools and demonstrate administrative systems options for decision-making, assigning responsibility, communicating and collecting information, and reporting results. The workshop will focus on customized technological tools that administrators may want to adopt for their own assessment and reaffirmation work.

Workshop 12: System Design for Program Assessment

Sunday, October 17, 8:30 - 11:30am

Location: Bay Resort/Convention Center, Bay 4

Primary Presenter: Julia Pet-Armacost, *University of Central Florida*

Additional Presenter: Robert L. Armacost, *University of Central Florida*

This workshop describes how to develop and implement a successful program assessment system in educational institutions of all sizes. Specific topics include: role of assessment in continuous improvement, characteristics of program assessment success, essential components of an assessment process, role of quality assurance in managing the process, organizational structures and support, and use of web technologies to facilitate program assessment. Participants will conduct self-assessment exercises followed by discussions designed to identify the state of assessment and identify opportunities to improve the assessment system at their institutions. The intended audience includes mid-level and senior personnel who have some responsibility for assessment.

Workshop 13: Assessing Expected Student Learning Outcomes Across the Curriculum: Course and Program-Embedded Tools and Methods

Sunday, October 17, 8:30 - 11:30am

Location: Bay Resort/Convention Center, Bay 5

Primary Presenter: Barbara H. Jones, *Somerset Community College*

Additional Presenters: Suzy Barr, *Trident Technical College*; Wesley A. Payne, *Southwest Tennessee Community College*

The adoption of the SACS’ *Principles of Accreditation* in 2003 requires that IE/IR professionals and academic and student support administrators take a new look at how expected student learning outcomes are identified, assessed, analyzed, and used for improvement at the course, program and institutional level. The best practices presented will include model programs and practices from a variety of colleges around the country. The tools presented will include assessment rubrics, logic model designs, common course exams, competency-based assessments, portfolios, and commercial and in-house examinations.

Workshop 14: Logistic Regression Analyses

Sunday, October 17, 8:30 - 11:30am

Location: Bay Resort/Convention Center, Bay 3

Presenter: Chau-Kuang Chen, *Meharry Medical College*

This workshop is intended for institutional researchers who want to learn different types of logistic regression analyses for describing the effects of explanatory variables on an outcome variable. The step-by-step procedure is illustrated to build and interpret the binary, ordered, and multinomial logistic regression models. The workshop focuses on the formulation of research questions, followed by the selection of the appropriate models, the interpretation of computer printouts, and the verification of model assumptions. All participants are welcome to replicate these techniques by utilizing the presented slides and SPSS commands. The intended audience is researchers with some knowledge of linear regression analysis.

1:00—4:00pm WORKSHOPS

Workshop 15: Enhancing Your SAS Programming Skills with PROC REPORT and the Output Delivery System

Sunday, October 17, 1:00 - 4:00pm

Location: Jefferson Davis Campus of MGCCC (shuttle from hotel lobby, 12:30pm), Building “X”

Presenter: Kathleen Morley, *Baylor University*

This workshop will provide hands-on instruction and practice using PROC REPORT and the output delivery system (ODS) from SAS. PROC REPORT combines features of the print, tabulate, and means procedures into one report-writing tool, and allows the user to have control over certain aspects of formatting such as column widths and break lines. Instruction for this procedure will include both simple detailed and summary reports. ODS will be used to produce high-quality output in a variety of formats – rich text format, html, and pdf. ODS also enables the programmer to control the format of the output such as column widths, colors, and fonts. Participants should have experience in using the SAS libname, data step, and other basic SAS functions. Participants will be provided with a CD containing sample data sets, programs, and a list of recommended references.

Workshop 16: Using Multiple Regression in Institutional Research

Sunday, October 17, 1:00 - 4:00pm

Location: Jefferson Davis Campus of MGCCC (shuttle from hotel lobby, 12:30 pm), Building “X”

Primary Presenter: Gary R. Pike, *Mississippi State University*

Additional Presenter: Corinna A. Ethington, *University of Memphis*

Institutional researchers are frequently called on to conduct multiple regression analyses. Widespread use of this powerful technique encourages us to revisit the principles underlying this “workhorse” of institutional research to identify ways in which it can be used to improve our research. Topics covered will include uses of regression, data structures, measurement of variables, model specification, and tests of significance and

substantive importance. The workshop will also examine the assumptions underlying multiple regression and the consequences of violating those assumptions. This is not an introductory workshop -- participants should have a working knowledge of regression techniques.

Workshop 17: Basic Statistical Reasoning

Sunday, October 17, 1:00 - 4:00pm

Jefferson Davis Campus of MGCCC (shuttle from hotel lobby, 12:30 pm), Building “B”

Presenter: Diane Saphire, *Trinity University*

This workshop is for those new to statistics or feeling the need for a refresher on the basics. The workshop will cover methods of gathering data, ways of summarizing and displaying data, and some techniques for drawing conclusions about a population based on the data in a sample. During this hands-on workshop, participants will use Excel to work with Institutional Research examples.

Workshop 18: A “Fast-Track” Approach to a Quality System: SACS and Documentation of Institutional Effectiveness

Sunday, October 17, 1:00 - 4:00pm

Location: Bay Resort/Convention Center, Bay 5

Primary Presenter: Patrice Moulton, *Northwestern State University*

Additional Presenters: Ram Goulu, *Northwestern State University*; Jim McCrory, *Northwestern State University*; Veronica Ramirez, *Northwestern State University*

Uncertainty is amidst as institutions consider options for integrating the new SACS initiatives and technology requirements with strategic planning cycles, individual program accrediting requirements, and IE plans. Institutions face struggles with determining models, developing processes, preparing faculty, staff, and administrators, and incorporating technology. Step-by-step, this presentation will describe how a midsize institution went about the process of developing a working system. Interactive demonstrations, examples and discussions will be facilitated regarding the organization and development of several components of a SACS system: Reference Room, Compliance Audit, and Site Management.

Workshop 19: The Integration of Strategic Planning, Budgeting, Operations, Assessments, and Continuous Improvements

Sunday, October 17, 1:00 - 4:00pm

Location: Bay Resort/Convention Center, Bay 4

Primary Presenter: Robert “Jerry” Norris, *The University of West Florida*

Additional Presenter: Jacqui Berger, *The University of West Florida*

This workshop is designed to assist (1) individuals new to strategic planning, (2) individuals working at institutions giving initial or renewed attention to the planning function, and (3) individuals whose institutions are facing SACS reaffirmation of accreditation criteria and want to strengthen their planning approach. The workshop will include participatory activities

including (1) the identification of strategic plan ingredients, (2) the development of a campus-wide strategic planning approach, (3) the development of a strategic planning calendar, (4) the review of a Web-based strategic planning model, and (5) a review of related SACS criteria. The presenters insist that the workshop will be informative and fun!

Sunday, October 17, 4:00—4:45pm
PRESENTERS AND FACILITATORS MEETING
 Convener: Jan Reid-Bunch, *Itawamba Community College*
 Location: Bay 8

Sunday, October 17, 4:00—4:45pm
VENDORS MEETING
 Convener: Lorne Kuffel, *College of William and Mary*
 Location: Bay 2

Sunday, October 17, 5:00—5:45pm
NEWCOMERS' RECEPTION
 Convener: Catherine Watt, *Clemson University*
 Location: Ballroom C

Sunday, October 17, 6:00—7:30pm
CONFERENCE OPENING SESSION
 Facilitator: Ross Griffith, *Wake Forest University*
 Location: Ballroom A/D
Music provided by "CenterStage" - students from Itawamba Community College, Fulton, Mississippi and directed by David East and Karen Davis.



Bill J. Leonard, Dean and Professor, Wake Forest University Divinity School in Winston-Salem, North Carolina, will present “Assessing a ‘Peculiar’ Community: Accreditation at a New Divinity School.” Dean Leonard’s presentation will indicate that the “host” university provided valuable infrastructure that enhanced the processes of accreditation and assessment for a new school. He will state also how the development of procedures for assessment involves not only connections with faculty and students, but with university procedures and response from a broader constituency related to churches, denominations, and community agencies.

Dean Leonard was appointed as the first Dean at the Wake Forest University Divinity School in 1996. Prior to being Dean, he was Chair of the Department of Religion and Philosophy at Samford University. Dean Leonard is the author of 15 books.

Sunday, October 17, 7:30—9:30pm
OPENING RECEPTION
 Location: Poolside
 Music is provided by *Itawamba Community College*.

Visit with vendors and your colleagues.

Sponsored by: Mississippi Gulf Coast Community College and SPSS, Inc.

MONDAY, OCTOBER 18

Monday, October 18, 7:30am—5:00pm
REGISTRATION
 Location: Bayview Convention Center Lobby

Monday, October 18, 7:30—8:15am
CONTINENTAL BREAKFAST AND SPECIAL INTEREST GROUPS
 Location: Lobby of the Convention Center
Sponsored by: National Student Clearinghouse and RTI International

AFFILIATED AND SPECIAL INTEREST GROUPS

- Kentucky Association for Institutional Research (KAIR)**
 Convener: Mary Korfhage, *University of Louisville*
 Location: Bay 2
- Louisiana Association for Institutional Research (LAIR)**
 Convener: Bernie Braun, *Louisiana State University*
 Location: Bay 8
- Mississippi Association for Institutional Research (MAIR)**
 Convener: Julie Fulgham, *Mississippi State University*
 Location: Ballroom B
- North Carolina Association for Institutional Research (NCAIR)**
 Convener: Anne Marie Bellamy, *Brunswick Community College*
 Location: Bay 3
- South Carolina Association for Institutional Research (SCAIR)**
 Convener: Tim Garner, *Technical College of the Lowcountry*
 Location: Bay 5
- Tennessee Association for Institutional Research (TENNAIR)**
 Convener: Sharon Yarbrough, *Pellissippi State Technical Community College*
 Location: Bay 4
- Texas Association for Institutional Research (TAIR)**
 Convener: Karen C. Laljiani, *El Centro College*
 Location: Bay 6
- Virginia Association for Institutional Research (VAMAP)**
 Convener: Jackie Bourque, *J.S. Reynolds Community College*
 Location: Bay 7

Monday, October 18, 7:30—8:15am
DINOSAURS' BREAKFAST (PAST PRESIDENTS)
 Location: Pascagoula

Monday, October 18, 8:30—9:45am
CONFERENCE GENERAL SESSION
 Facilitator: Ross Griffith, *Wake Forest University*
 Location: Ballroom A/D



Beverly W. Hogan, President, Tougaloo College in Tougaloo, Mississippi, will present **“Creating a Culture of Institutional Effectiveness.”** President Hogan’s presentation will address the strategic dynamics of Institutional Research, Planning and Assessment; tools that are essential in achieving institutional effectiveness within a changing climate of higher education.

She will address why it is important to create a campus culture that values institutional effectiveness, speaking to the larger issue of what does all of this really mean for colleges and universities today.

President Hogan was appointed President at Tougaloo in May 2002. She brought to the college twenty-five years of experience in executive management and leadership including her service as the Executive Director of the Governor’s Office of Federal State Programs.

Principles, which included an off-site review in the fall of 2003 and an on-site visit in April, 2004. The other panelists served as on-site evaluators during this first implementation cycle. Panelists will share “lessons learned” from their experiences and suggest implications for those who will be preparing for accreditation visits in 2005 or later. Information will be included on the Compliance Certification, Quality Enhancement Plan (QEP), Focus Report, and on-site review.

Monday, October 18, 10:00 - 10:45am
PAPER

Early and Late Bloomers (Graduates): What Leads Students Down These Magnolia Paths?

Track: Assessment

Primary Presenter: Debbie Dailey, *Georgetown University*
 Facilitator: Lesley Hamm, *Georgia Institute of Technology*
 Location: Pascagoula

Discussions about graduation rates pay little attention to students who complete their degrees early, in less than four years. A study was undertaken at a private, highly-selective university to examine the characteristics of students who complete their course work ahead of schedule. Another group of students, the late graduates, those taking more than four years to graduate, were examined to see how they differ from the early graduates. Anyone with an interest in how students progress to earning their college degrees or an interest in policy implications of the topic will find this paper of interest.

Monday, October 18, 10:00 - 10:45am
PAPER

Spirituality in Higher Education: Findings from the 2003 College Students’ Beliefs and Values Survey

Track: Assessment

Primary Presenter: Jennifer A. Lindholm, *Higher Education Research Institute, UCLA*

Additional Presenter: Alyssa N. Bryant, *Higher Education Research Institute, UCLA*

Facilitator: Gwen Aldridge, *Northwest MS Community College*
 Location: Bay 6

This session provides an overview of a national, longitudinal study on college student spirituality funded by the John Templeton Foundation. We will describe the origins and goals of this research initiative and highlight findings. Specifically, we will present summative information on student attitudes, perceptions, and experiences. We will also detail differences based on individual factors including gender, academic major, and political orientation. Session participants will be engaged in considering the scholarly and practical implications of our findings to date.

CONCURRENT SESSIONS

Monday, October 18, 10:00 - 10:45am
PANEL

Complying with SACS Principles of Accreditation: Lessons Learned from the First Cycle of Implementation

Track: Accreditation

Primary Presenter: Harriott D. Calhoun, *Jefferson State Community College*

Additional Presenters: Gerry Dizinno, *St. Mary's University*;
 Jim Eck, *Rollins College*

Facilitator: Sara Gravitt, *Wake Forest University*
 Location: Bay 5

With the implementation of the SACS Principles of Accreditation: Foundations for Quality Enhancement, the question now is, “What must institutions do to comply with the new requirements?” This panel will consist of persons who have been involved in the first cycle of implementation. One panelist is from an institution that is conducting its reaffirmation under the

Monday, October 18, 10:00 - 10:45am

CORPORATE DEMONSTRATION

Collegiate Learning Assessment: New Measures for Benchmarking Undergraduate Student Development

Track: Assessment

Primary Presenter: Marc Chun, *RAND Council for Aid to Education (CAE)*

Additional Presenter: Roger Benjamin, *RAND Council for Aid to Education (CAE)*

Facilitator: Mary Harrington, *University of Mississippi*

Location: Bay 2

A new set of assessment tools are now available for measuring institutional contributions to undergraduate student learning. RAND's Collegiate Learning Assessment (CLA) project presents measures that are performance-based, administered wholly online, and chart growth in critical thinking, analytic reasoning and written communication skills. The measures simulate real-world scenarios and through open-ended responses assess students' demonstrated ability. The discussion will focus on ways the CLA can be used in institutional self-assessment and inter-institutional comparisons as a means to support curricular reform and academic program improvement (including studies of the retention and academic success of minority students).

Monday, October 18, 10:00 - 10:45am

PAPER

A Comprehensive Web-based Institutional Effectiveness System that Provides a Method of "Closing the Loop" Electronically

Track: Community College

Primary Presenter: Glenda Colagross, *Northwest-Shoals Community College*

Facilitator: Angela Detlev, *University of Richmond*

Location: Bay 3

Modern technology provides the vehicle necessary for institutions to tie together all of the segments involved in the annual planning cycle electronically. This session will highlight the design and development of a comprehensive web-based institutional effectiveness system that contains the various elements which are necessary to "close the loop" between institutional mission, planning (including needs analysis and budgeting), evaluation, and use of results. This completely electronic system automates the process of developing budget requests and technology/equipment purchasing plans and then automatically links these items back to specific goals and objectives.

Monday, October 18, 10:00 - 10:45am

SOFTWARE DEMONSTRATION

Doing More With Less! A hands-on demonstration of a one-stop shop institutional research solution for small community colleges.

Track: Community College

Primary Presenter: Edwin Litloff, *Baton Rouge Community College*

Additional Presenter: Kimberly D. Kirkpatrick, *Louisiana Community & Technical College System*

Facilitator: Adam Shick, *Wake Forest University*

Location: Bay 8

The session is a one-stop solution that provides an institutional research office access to reporting tools, databases, surveys, mail merges, surveys, performance indicators, benchmark institutions, and environmental scanning using Microsoft Access. Share data and provide college-wide resources. The session is very hands on and provides demonstration CDs for immediate use.

Monday, October 18, 10:00 - 10:45am

PAPER

College Math Performance and Time Since Last High School Math Course

Track: Institutional Research

Primary Presenter: Cara Mia Pugh, *Auburn University*

Additional Presenter: Sam Lowther, *Auburn University*

Facilitator: Cornelia Wills, *Middle Tennessee State University*

Location: Bay 4

Only half of high school graduates take math during their senior year (NCES, 2004), while at a large research university mathematics faculty report poor performance in college level coursework. This study examines performance in college math core courses in relation to time since last high school math course. Results, examined by year of last high school math course, assess whether high school math GPA improves prediction of college core math grades over ACT/SAT sub-scores and an institution-designed college math placement test. Findings have implications for advising, predicting college success, and providing feedback to high schools.

Monday, October 18, 10:00 - 10:45am

PAPER

Faculty and Staff Salary Planning - Models to Predict Salaries and Benefits

Track: Planning

Primary Presenter: Jessica Swink, *Clemson University*

Additional Presenter: Ronnie Chrestman, *Clemson University*

Facilitator: Lesa Jeansonne, *Louisiana State University*

Location: Ocean Springs

Many institutions are faced with budget cuts and increased demands upon financial resources. Faculty and staff salaries make up the single largest part of the budget at institutions of higher education. The models that will be presented are one institution's attempt to plan for the changes in salaries and the total funds needed to meet those needs over time. Many factors such as retirements and rehiring practices, program growth or reduction, increasing or decreasing employee numbers, institutional policies, and goals for salaries play different roles in the salary model. In this presentation, two goals for salaries will be presented. One model defines a specific goal for salaries and gives a roadmap for obtaining that goal, while a second model provides "what if" scenarios for raises and rehiring practice. Copies of the models will be available for distribution.

Monday, October 18, 10:00 - 10:45am

PAPER

National Lumina Study of Non-Credit Course Activity

Track: Planning

Primary Presenter: John Milam, *HigherEd.org, Inc.*

Facilitator: Darla Keel, *University of Memphis*

Location: Biloxi

This paper describes the results of a new national study of non-credit course activity, which is funded by the Lumina Foundation. It is expected that a previously hidden portrait of postsecondary education will emerge. The study focuses on the following: (1) the national perspective, as seen through NCES and associations such as AACC, ACE, and The League for Innovation in the Community College; (2) the state perspective, as seen through state agencies and the SHEEO association; and (3) the institutional perspective, documenting the availability of data and interest in non-credit course activity policies at degree-granting, two- and four-year institutions.

Monday, October 18, 10:00 - 10:45am

SOFTWARE DEMONSTRATION

SQL for IR Staff: A crash course for novices in appropriately selecting and transforming data from relational databases.

Track: Technology

Primary Presenter: Evan Davies, *College of William and Mary*

Additional Presenter: Dennis Catley, *Virginia Tech*

Facilitator: Debbie Head, *Kennesaw State University*

Location: Bay 7

Institutional researchers are increasingly using SQL applications within software packages to access data from relational databases. Training in SQL techniques is generally non-existent, less than compelling, or both. Many training opportunities use grocery store examples, do not focus productively on selection procedures, or are too simplistic for the type of data needed by researchers. Drag-and-drop SQL generators often do not offer the flexibility necessary to select desired data without modifying the generated query. This demonstration will give the novice SQL user the ‘concept-bridging’ information necessary to begin understanding and writing SQL queries to select appropriate data from university-related databases.

11:00—11:45am CONCURRENT SESSIONS

Monday, October 18, 11:00 - 11:45am

CORPORATE DEMONSTRATION

Using the CIRP, YFCY and CSS Surveys to Study Your Students

Track: Assessment

Primary Presenter: Kit Mahoney, *Higher Education Research Institute, UCLA*

Facilitator: Donald Cunningham, *University of Tennessee*

Location: Bay 3

UCLA's Higher Education Research Institute conducts the Co-

operative Institutional Research Program (CIRP), a continuing study assessing the effects of college on students. The CIRP provides information on entering students, including demographics, expectations, and major plans; and a "base-line" for future studies. Colleges can conduct longitudinal assessments with CIRP follow-up surveys. Your First College Year assesses the academic and personal development of students during their initial college year. The College Student Survey focuses on students toward the end of college. Both surveys track a cohort's matriculation. Survey reports enhance studying retention; understanding students' values, attitudes and goals; and examining campus issues.

Monday, October 18, 11:00 - 11:45am

SOFTWARE DEMONSTRATION

Developing a Dynamic Faculty Activity Reporting System

Track: Assessment

Primary Presenter: Sabrina Andrews, *University of Central Florida*

Additional Presenters: Betty Miller, *University of Central Florida*; Shiva Jaganathan, *University of Central Florida*

Facilitator: Sara Gravitt, *Wake Forest University*

Location: Bay 8

Most institutions maintain records related to “faculty activity” for reporting purposes. This would include activities related to teaching, research, and public service. This demonstration shows how a large, metropolitan university transformed its legacy-based faculty activity reporting system to a user-friendly, web-based reporting environment. Topics to be discussed include the stages of development, the key reporting requirements, the queries developed for edit checking and balancing, as well as key management reports.

Monday, October 18, 11:00 - 11:45am

CORPORATE DEMONSTRATION

TracDat Assessment Management Software by Nuventive

Track: Assessment

Primary Presenter: Denise Raney, *Nuventive*

Additional Presenter: Alan Buckner, *Nuventive*; Charles Hawkins, *North Georgia College and State University*

Facilitator: Jim Purcell, *Oklahoma State Regents for Higher Education*

Location: Bay 5

TracDat is a Web-based assessment management tool that aids in strategic planning and helps institutions prepare for accreditation and manage their assessment process with a focus on program improvement. TracDat's templates assure a uniformity of reporting that simplifies collection, review, management, and utilization of assessment data. Nuventive will demonstrate TracDat. A brief description of iWebfolio, Nuventive's electronic portfolio system will be given and the linkage to TracDat for the collection of learning evidence for assessment will be discussed.

Monday, October 18, 11:00 - 11:45am

PAPER

Benchmarking Institutional Effectiveness in Student Engagement — A Multidimensional Investigation of Engagement and Academic Performance

Track: Community College

Primary Presenter: C. Nathan Marti, *The University of Texas*

Facilitator: Karen Bauer, *The University of Georgia*

Location: Bay 2

In the current context of accountability measures following the Reauthorization of Higher Education Act, colleges and universities are increasingly benchmarking performance. That effort requires the development of an extensive framework of measures, one of which is benchmarking educational effectiveness based on the students' experiences. The amount of time and energy that students spend engaged in educationally meaningful activities has consistently been shown to be related to desired learning and personal development outcomes (Pace, 1980). To examine the existence of such a relationship in a benchmark measure, hierarchical linear models were used to regress grade point average on benchmarks of effective educational practice measured using the Community College Survey of Student Engagement (CCSSE). Results showed positive relationships between key engagement areas and grade point average.

Monday, October 18, 11:00 - 11:45am

PAPER

Understanding UA Enrolled Students' Attendance at Shelton State Community College

Track: Community College

Primary Presenter: Jon Acker, *The University of Alabama*

Additional Presenters: William Hughes, *University of Alabama*;

William R. Fendley, Jr., *Wayne State University*

Facilitator: Mary Gunn, *Coastal Carolina University*

Location: Pascagoula

Shelton State Community College (SSCC) attracts many enrolled University of Alabama (UA) students. The loss of credit hours taken at SSCC represents a loss of revenue for The University, not only in tuition, but also in state funding. Thus, it was decided to look more closely into why UA students concurrently enroll at SSCC. The findings seem to indicate that SSCC may actually benefit UA by fostering greater retention of its students by providing a "relief value" for students struggling with finances, convenience issues, language issues, or the adjustment from high school to a large university.

Monday, October 18, 11:00 - 11:45am

PAPER

Does Level of Engagement Really Matter? An Alternative Approach to Examine the Association Between NSSE Data and Persistence

Track: Institutional Research

Primary Presenter: Huiming 'Ming' Wang, *Clayton College and State University*

Additional Presenter: Sharon Long, *Clayton College and State*

University

Facilitator: Pam King, *The Citadel*

Location: Ocean Springs

This study examines the possible links between levels of student engagement and undergraduate persistence. Merging NSSE 2003 institutional data with the immediate summer and fall persistence/graduation status, only the first-year students showed positive relationships between scope and extent of engagement and persistence. Implications for NSSE sample selection and data analysis procedures as well as institutional accountability efforts are presented.

Monday, October 18, 11:00 - 11:45am

PAPER

U.S. News & World Report's America's Best Colleges Rankings: A look inside the process

Track: Institutional Research

Primary Presenter: Robert J. Morse, *U.S. News & World Report*

Facilitator: Bruce I. Mallette, *RTI International*

Location: Ballroom D

A review of the America's Best Colleges ranking methodology and key changes made in the rankings published in August 2004. What does *U.S. News* give back to institutional researchers and their colleges for free?

Monday, October 18, 11:00 - 11:45am

SOFTWARE DEMONSTRATION

Leading Change Through A Web-Based Strategic Planning and Budgeting Model

Track: Planning

Primary Presenter: Marsha V. Krotseng, *Valdosta State University*

Facilitator: Roy D. Ikenberry, *Belmont University*

Location: Bay 6

Strategic planning – thoroughly understanding an institution's strengths and weaknesses and carefully charting future directions – is a key to effective leadership of colleges and universities. In the current economic environment, strategic planning and budgeting are more critical than ever as institutions assess and reinforce their priorities through sound decision making and resource allocation. Integrated planning and budgeting also are integral to institutional change. This demonstration focuses on effective use of a web-based strategic planning model at a comprehensive regional university. This system enables the institution to allocate resources toward its highest priorities, thus leading to outcomes envisioned in the strategic plan.

Monday, October 18, 11:00 - 11:45am

PAPER

Organizing a State Organization

Track: Planning

Primary Presenter: Verna L. Dewees, *The Texas A&M University System*

Additional Presenter: Maryann Ruddock, *The University of Texas at Austin*

Facilitator: Robert Armacost, *University of Central Florida*
 Location: Bay 4

The main objective of this session is to encourage the organizational development of state-level AIR affiliates. With SAIR and a number of its affiliates reaching the 30-year mark in their history, organizational theory concerning the maturity of organizations has a lot to offer to our state affiliates. SAIR state affiliates all face a number of common issues: non-profit status, managing of finances, size and scope of professional development activities, etc. State-level affiliates can learn from one another in ‘how to run and to manage an organization’—this session will facilitate that exchange of information.

Monday, October 18, 11:00 - 11:45am

SOFTWARE DEMONSTRATION

Getting the Data into the Hands of Decision-Makers: Deployment of Custom Web Applications Powered by SPSS

Track: Technology

Primary Presenter: Sherri Sahs, *Embry-Riddle Aeronautical University*

Facilitator: Allen Gale, *Xavier University*

Location: Bay 7

In order to provide university decision-makers with better access to IR data, an initiative was undertaken to move from static web data views and hard copy reports to dynamic access to the actual data through a Web environment. SPSS WebApp allows users to analyze data (from relational database or native SPSS formats) stored on a server, via a Web browser without use of additional plug-ins or other proprietary applications. Customized interfaces allow successful deployment of canned, interactive and ad hoc analyses and reports. This demonstration will showcase different applications built including summary data views and ad hoc queries powered by SPSS analytics.

Monday, October 18, Noon—1:00pm

LUNCHEON ROUNDTABLES

Location: Ballroom B/C

Sponsored by: RTI International

LUNCHEON ROUNDTABLES

ROUNDTABLE 1

International Peacekeeping 101: Lessons in Cooperation for Institutional Researchers

Track: Planning

Primary Presenter: David Allen, *Fayetteville State University*

An allegorical model wherein the U.S. forces represent IR offices and Coalition forces represent faculty, staff and others is used as the basis of an investigation of ways cooperation between IR professionals and others can be increased and improved. The presenter will share the findings of the investigation and invite discussion of the results.

ROUNDTABLE 2

Distance Learning Evaluation at Community Colleges: Verifying that New Technologies in Educational Delivery Satisfy Students and Faculty

Track: Technology

Primary Presenter: Anne Marie Bellamy, *Brunswick Community College*

While distance learning affords the opportunity for on-going evaluation with central posting of assessment tools, systematic feedback needs to occur early in the course to make the necessary adjustment to facilitate the learning process. Uses of ongoing assessment feedback will be suggested. New methods of evaluation to verify learning is on track for continuous and future course improvements will be discussed.

ROUNDTABLE 3

Evaluating Courses Offered in Concentrated Time Periods

Track: Institutional Research

Primary Presenter: Harriott D. Calhoun, *Jefferson State Community College*

This discussion will focus on issues relating to the evaluation of courses offered in concentrated or abbreviated time periods, including course selection and scheduling, comparability of content and learning outcomes, and satisfaction of students and instructors.

ROUNDTABLE 4

Perceptions of Student Effort

Track: Assessment

Primary Presenter: Sarah Carrigan, *University of North Carolina at Greensboro*

Results of a study of faculty members’ expressed expectations of student preparation outside the classroom, faculty perceptions of student preparation, and students’ self-report of study time will be discussed. Findings suggest more explicit communication between faculty and students is warranted.

ROUNDTABLE 5

Diversity Initiative: A Promising Pilot to Increase Student Awareness

Track: Assessment

Primary Presenter: Angela Detlev, *University of Richmond*

A new program called Collegetown, designed to increase diversity and diversity awareness among campus students, faculty, and staff, was piloted using a retreat format. Intensive interactive sessions designed to challenge students to think critically about issues of diversity and empower them to work toward campus change resulted in substantial increases in awareness and willingness to inform others on campus of issues surrounding diversity. Come discuss the project and its implications for other campuses.

ROUNDTABLE 6

Preparing for the SACS/COC Visiting Team: Do No Harm, Possibly Do Some Good

Track: Accreditation

Primary Presenter: Gerry Dizinno, *St. Mary's University*

The process of reaffirmation, whether by using the “old” or the “new” way, involves years of campus planning and work. Less than satisfactory experiences of visiting team members can “taint” all that work. Discussion, led by an experienced peer reviewer and coordinator of his institution’s reaffirmation visit arrangements, will focus on the pre-trip and on-campus arrangements that have been effective in providing a positive experience for visiting team members.

ROUNDTABLE 7

“Been There, Done That” The New SACS Reaffirmation Process in Community Colleges

Track: Accreditation

Primary Presenter: Cathy M. Ellett, *Copiah-Lincoln Community College*

With only a few institutions currently in the middle of the “New” SACS reaffirmation process, many are curious about how the process is working. Copiah-Lincoln Community College just completed its on-site visit. The accreditation process used by the college will be shared.

ROUNDTABLE 8

Faculty Engagement and Rising Quality Standards: Outcomes of Graduate Assessment Planning and Implementation

Track: Assessment

Primary Presenter: Diane S. Gilleland, *University of Arkansas at Little Rock*

Additional Presenter: SueAnn Strom, *University of Arkansas at Little Rock*

The important outcomes of a comprehensive assessment effort in a doctoral program and key elements required for designing an effective assessment program will be shared. Attendees will leave with models of a process and timelines, unified assessment plan, curriculum map, assessment matrix, core knowledge, skills, and dispositions developed in a higher education doctoral program.

ROUNDTABLE 9

A “Colorful” Approach to Team Building

Track: Institutional Research

Primary Presenter: Mary Harrington, *University of Mississippi*

According to The Diagonal Group, people can be divided into four colors, each having distinctly different personality traits and behaviors. For example, “Reds” are challenging, competitive and demanding, whereas “Greens” are thoughtful, value-based and caring. Learn how to recognize these differences to communicate more effectively and ensure that your teams are compatible and productive.

ROUNDTABLE 10

Concurrent Enrollment in Developmental and Credit Courses

Track: Community College

Primary Presenter: Paul Illich, *McLennan Community College*

This discussion relates a study that assessed the college-level performance of students concurrently enrolled in developmental courses and credit courses that were not related to the student’s developmental need. The results of the study and policy implications of the results will be discussed.

ROUNDTABLE 11

Institutional Integrity and Institutional Research: The First Date

Track: Institutional Research

Primary Presenter: Larry G. Jones, *University of Georgia*

Institutional integrity is a prominent concept in the regional accrediting associations and colleges and universities. Discussion will focus on common ground on which to consider the issues of institutional integrity and how one determines its presence and level.

ROUNDTABLE 12

Changes in Attitudes

Track: Institutional Research

Primary Presenter: John Kalb, *Southern Methodist University*

Additional Presenter: C. K. Allen, *Southern Methodist University*

Changing from a public to a private university causes some re-evaluation. Both roundtable conveners have recently changed from public universities in two different state systems to a private university. How do these two worlds differ? How are they similar?

ROUNDTABLE 13

PR for IR: Incorporating Public Relations Within the Institutional Research Office

Track: Institutional Research

Primary Presenter: Jim Purcell, *Oklahoma State Regents for Higher Education*

Discussion will focus on IR offices’ use of opinion research, intelligence gathering, service promotion, publicity, public affairs, and lobbying to help maintain and/or increase its presence though out the institutional community and beyond.

ROUNDTABLE 14

Maintaining Institutional Commitment to Assessment/Improvement Activities Between Reviews by the Commission on Colleges

Track: Accreditation

Primary Presenter: James O. Nichols, *Institutional Effectiveness Associates*

Additional Presenter: Karen W. Nichols, *Institutional Effectiveness Associates*

Achieving institutional focus on assessment/improvement activities seems relatively easy before and during review by the Commission on Colleges compared to maintaining the institution's commitment to the process until the next reaffirmation. The conveners, experienced practitioners in the field of institutional effectiveness for almost twenty years, will share their experiences and anecdotes regarding means through which to maintain institutional commitment. Participants will be asked to share their own experiences.

ROUNDTABLE 15

Using Base SAS in an IR Office

Track: Institutional Research

Primary Presenter: Michel Schexnayder, *Louisiana State University*

The following Base SAS topics will be presented: appending files for longitudinal reports, percent change reports, inserting variable data in report titles, report historical data according to current university structure, user defined formats, style changes of PDF and HTML output using proc template, and PDF document table of contents.

ROUNDTABLE 16

Establishing and Maintaining a Good Relationship with IT

Track: Institutional Research

Primary Presenter: Jill Stribling, *University of Mississippi*

One of the most difficult tasks among IR, Assessment and Planning colleagues is the struggle to maintain a viable line of communication with Information Technology. Discussion will focus on the key to establishing relationships that transcend the "language barrier" posed by operating different types of businesses.

ROUNDTABLE 17

From Spark Plugs to Students: One Researcher's Road Trip

Track: Institutional Research

Primary Presenter: Stephanie Thompson, *University of Memphis*

What is the best place to look for qualified talent? Educational/IR background or corporate? This discussion relates the current make-up of IR offices within SAIR and compares and contrasts the backgrounds of members. Though not as disparate as you may think, each background has a distinct skill set to bring to your organization.

ROUNDTABLE 18

The SPACE Consortium: Academic Space Management & the Role of Institutional Research

Track: Planning

Primary Presenter: Catherine E. Watt, *Clemson University*

Additional Presenter: Thomas B. Higerd, *Medical University of South Carolina*

The SPACE Consortium is founded to improve knowledge of academic space use at institutions. Administrators must make

decisions based on databases with robust descriptors. Reports on space allocation will be shared and tools used to create the reports will be described.

CONCURRENT SESSIONS

Monday, October 18, 1:15 - 2:00pm

PANEL

A Voluntary Self Study of the First Year: IR Perspectives on the Foundations of Excellence Project

Track: Assessment

Primary Presenter: Heather Langdon, *Appalachian State University*

Additional Presenter: Lisa Cooper, *Georgia Southwestern State University*

Facilitator: Tim Garner, *Technical College of the Lowcountry*

Location: Bay 8

Since spring 2003, twenty-four college and university campuses participated as Founding Institutions in a voluntary self study of their students' first year experiences. This project is entitled Foundations of Excellence in the First College Year. The project was developed and led by the Policy Center on the First Year of College. In this panel presentation session, IR Founding Institution task force members will discuss what they have learned about their campuses and how their IR, assessment, and retention research practices have been informed through involvement with the Foundations of Excellence.

Monday, October 18, 1:15 - 2:00pm

PAPER

The IR Professional's Role in a Multifaceted Program Evaluation

Track: Assessment

Primary Presenter: Karen Webber Bauer, *University of Georgia*

Facilitator: Annette Accomando, *Nunez Community College*

Location: Ballroom D

This presentation describes the research design and IR members' role in a multi-year research project that sought to evaluate the effectiveness of an academic support program, The Undergraduate Research Program (URP) at a research university. The four main components of the evaluation will be discussed as well as the origin of the project, the collaborative role of the IR professional, and implications for the inclusion of program evaluation responsibilities as part of the IR professionals' workload.

Monday, October 18, 1:15 - 2:00pm

PAPER

Persistence and Performance of Community College Students: Transferring to a Private Research University

Track: Community College

Primary Presenter: Joachim Knop, *George Washington University*

Additional Presenter: Kim Dam, *George Washington University*

Facilitator: Adam Shick, *Wake Forest University*

Location: Bay 2

In this case study, a private research university presents the academic outcomes of former community college students who were accepted as transfer students. Time-to-degree, institutional GPA, level of satisfaction with the educational experience, and level of intellectual challenge will be compared to the traditional first-time freshmen population and to the student population who transferred from four-year colleges and universities.

Monday, October 18, 1:15 - 2:00pm

PAPER

Student Outcomes: A Temporal Analysis of the Effects of Academic Scheduling on Student Outcomes in Remedial English and Mathematics Courses

Track: Community College

Primary Presenter: David F. Mullins, *East Mississippi Community College*

Facilitator: Barbara Poole, *Bossier Parish Community College*

Location: Pascagoula

This study compares the outcomes of community college students in remedial English and mathematics courses from 1998-2003. The study sample is drawn from a small, rural community college in the southern United States. Using regression analysis, student outcomes are analyzed by frequency of weekly class meetings, while controlling for various student demographics (e.g., race, gender, mother's education, ACT score, career technology major, term GPA, semester credit hours attempted). Findings from this study indicate that the frequency of weekly class meetings of remedial courses influences students' grades but not the probability of course completion. There is a positive relationship between increased weekly class meetings and higher grades, while class size impacts the probability of completing remedial English and mathematics courses.

Monday, October 18, 1:15 - 2:00pm

PAPER

Using Data Mining Predictive Modeling to Develop Predictive Models for Matriculation and Academic Performance Success

Track: Institutional Research

Primary Presenter: Meihua Zhai, *George Mason University*

Additional Presenters: Mary Esther Perry, *George Mason University*; Ken Lee, *George Mason University*

Facilitator: Ruth Salter, *Valdosta State University*

Location: Bay 6

With scanty resources, increasing competition for viable applicants and demands to improve college persistence rates, a more robust model is needed that will allow public universities to allocate their limited resources in a more focused way to recruit students who are not only likely to enroll, but also succeed after their matriculation. This research paper will describe the building of a predictive model in SAS Enterprise Miner and the model assessment. Predictive modeling techniques such as logistic regression, tree-analysis and neural network will be discussed. The accuracy of prediction, misclassification tolerance and robustness of various models will be compared.

Monday, October 18, 1:15 - 2:00pm

PANEL

Web IPEDS – New Strategies for Data Collection

Track: Institutional Research

Primary Presenter: Susan Broyles, *National Center for Education Statistics*

Additional Presenter: Janice A. Plotczyk, *National Center for Education Statistics*

Facilitator: Janice E. Kelly-Reid, *RTI International*

Location: Bay 7

Institutional researchers and others must be prepared for the changes that are coming to IPEDS over the next several years. As new issues arise and policy makers are faced with new challenges, the National Center for Education Statistics (NCES) must prepare to meet the changing needs of our data users and providers. This panel will focus on the efforts that NCES is taking to better address the need for accountability, the challenges that may come with the reauthorization of the Higher Education Amendments, and some really cool tools that have been developed. Panelists will also discuss changes to future data collections and the incorporation of suggestions made by the Technical Review Panels.

Monday, October 18, 1:15 - 2:00pm

PAPER

Florida's Performance-Based Funding Initiative: National and International Contexts

Track: Planning

Primary Presenter: David Kreitner, *Keiser Collegiate System*

Additional Presenter: William Ritchie, *Keiser Collegiate System*

Facilitator: Dana Dalton, *Winston-Salem State University*

Location: Bay 5

This paper describes the history and current status of performance-based funding as a component of Florida's total workforce development effort. The Florida experience is framed in the context of the national performance funding movement in U.S. higher education, driven by global economic developments.

Monday, October 18, 1:15 - 2:00pm

PAPER

Graduate Program Self-analysis

Track: Planning

Primary Presenter: Lynn W. Varner, *Delta State University*

Additional Presenters: Paul Starkey, *Delta State University*;

Reid Jones, *Delta State University*; Tyrone Jackson, *Delta State University*

Facilitator: Charles H. Parker, *Midlands Technical College*

Location: Ocean Springs

The recent reconstitution of a centralized graduate studies office at Delta State University created an impetus for a study of the current situation on campus and of universities within the region. The process was in keeping with accreditation standards as well as the university's belief in self-study to provide for data-driven decision making. Phone interviews of 14 peer institutions were conducted. The 20 graduate program coordinators on campus and 214 current graduate students were surveyed. The Student Survey Inventory was given to a stratified, cluster sample of current graduate students. Data analysis revealed areas for improvement and recommendations were made to the graduate office.

Monday, October 18, 1:15 - 2:00pm

CORPORATE DEMONSTRATION

SAS Made Easy: An Introduction to Enterprise Guide

Track: Technology

Primary Presenter: James C. Ford, *SAS*

Facilitator: Dexter Alexander, *Somerset Community College*

Location: Bay 3

The purpose of this presentation is to show you how SAS Enterprise Guide (EG) for Windows can be used for all your teaching and research needs -- whether you are an experienced SAS user or have never used SAS before. EG is a thin client interface to the SAS System that provides you transparent access to data, point-and-click usability, a customizable user interface, and easy export of your results to other software applications. This demonstration will introduce you to EG to explore and analyze data, and then use the output to write reports and give presentations about your findings.

Monday, October 18, 1:15 - 2:00pm

CORPORATE DEMONSTRATION

eListen Survey Software

Track: Technology

Primary Presenter: Janet Woo, *Scantron*

Facilitator: Dorothy S. Cheagle, *Morris College*

Location: Bay 4

eListen is a unique survey software that allows the use of paper-based and online survey construction, deployment, collection, analysis, and reporting. In this session, Senior Account Executive Janet Woo will demonstrate the powerful features and ease of use with this turnkey survey solution.

2:15—3:00pm CONCURRENT SESSIONS

Monday, October 2:15 - 3:00pm

PAPER

Engagements Differing: NSSE Results Comparing Different Course Delivery Environments

Track: Assessment

Primary Presenter: Patricia DeWitt, *Shorter College*

Facilitator: Cathy Ellett, *Copiah-Lincoln Community College*

Location: Pascagoula

The National Survey of Student Engagement has been administered twice at our institution, sampling students in two very different course delivery environments: a traditional semester system and an adult-oriented continuous system. NSSE data were re-analyzed by IR to present results for four groups: traditional first-year, traditional senior, adult first-year, and adult senior. The patterns of engagement fall mostly into two categories: those reflective of the necessarily differing environments and student bodies, and those that are the result of educational choices made independently of environment. Differing results between environments suggest they should be two institutions for NSSE purposes.

Monday, October 18, 2:15 - 3:00pm

PAPER

Listening to Students: Results from a First-year / Sophomore Experience Survey

Track: Assessment

Primary Presenter: Angela Detlev, *University of Richmond*

Facilitator: Edie Carter, *Radford University*

Location: Bay 3

During spring 2003, the university administered an on-line survey to all first-year and sophomore students. The institutional-designed survey, entitled First-Year/Sophomore Experience Survey (FYSS), examined student satisfaction with their academic experiences, campus facilities, residential life, social life and activities, the college transition process, and student campus involvement. Data from the survey were given to relevant departments within student affairs to inform the planning process in order to increase student retention and satisfaction.

Monday, October 18, 2:15 - 3:00pm

PANEL

Selecting Appropriate Institutional Assessment Strategies: Three Institutions, Three Models

Track: Assessment

Primary Presenter: Susan Bosworth, *College of William and Mary*

Additional Presenters: Karen Gentemann, *George Mason University*; Alexei G. Matveev, *Norfolk State University*; Nuria M. Cuevas, *Norfolk State University*

Facilitator: Bruce I. Mallette, *RTI International*

Location: Bay 4

Three institutions, three approaches to assessment. Each ap-

proach is rigorous. Each approach leads to improvement. No approach is interchangeable. Assessment strategies should differ - but how and why, and how do we decide what will be most effective at our institutions? In this panel presentation, we identify salient factors in selecting appropriate assessment strategies for an institution. Using comparative case studies, we take a deliberate look at how and why our missions, students, faculties, administrators, and cultures make a difference in the questions we ask, the methods we use, and the standards by which we measure success.

Monday, October 18, 2:15 - 3:00pm

PAPER

What We Can Learn About Students who Persist to Degrees: Findings from Longitudinal Analyses of Multiple Survey Instruments.

Track: Assessment

Primary Presenter: Bobby Sharp, *Appalachian State University*

Additional Presenter: Heather Langdon, *Appalachian State University*

Facilitator: Carol Kayla, *West Virginia University*

Location: Bay 5

If the mission of an institution of higher education is to prepare educated productive citizens for society, then should not completion of a degree serve as a—perhaps the—primary indicator of institutional effectiveness for that institution, even if the degree is earned at a different institution? This paper presents methodologies and findings in the use of a complex battery of survey instruments and offers conclusions drawn about the instruments' usefulness in understanding students' enrolling through the attainment of degrees either at a large, traditional, comprehensive university or at another institution.

Monday, October 18, 2:15 - 3:00pm

CORPORATE DEMONSTRATION

Visionaire NetSurvey

Track: Assessment

Primary Presenter: Levi Bailey, *Visionaire*

Additional Presenter: Heidi Jordan, *Coastal Carolina University*

Facilitator: Lily Hwang, *Morehouse College*

Location: Bay 2

Visionaire's NetSurvey is an all-in-one survey management package designed specifically for universities. NetSurvey makes it easy to create, manage, and publish web surveys. With NetSurvey, it is extremely simple to manage semester classes and enrollment data. It is also very simple to import paper survey results into NetSurvey. NetSurvey comes packaged with our powerful XML defined reporter. Pre-written reports come built in, with the power to design and execute specialized reports. Our reporter produces XML and XSL files, so that reports are automatically web-ready. Visionaire's NetSurvey software can be hosted on Visionaire's servers or in-house.

Monday, October 18, 2:15 - 3:00pm

PANEL

The SACS QEP: How To and What is Expected

Track: Community College

Primary Presenter: Patricia Abell, *Guilford Technical Community College*

Additional Presenter: Patricia Perry, *Wilson Technical Community College*

Facilitator: Donald Boeckman, *Southeastern Louisiana University*

Location: Ballroom D

Guilford Technical and Wilson Technical Community Colleges have both just finished their SACS on-site visits and they have some information you can use as you develop your college's Quality Enhancement Plan and anticipate your own campus visit. You will find out how our plans were developed, what we learned, what we would do differently, and how we were evaluated. Take advantage of our 'expertise' and our 'mistakes' to give your college the 'hindsight' necessary to develop an acceptable and viable QEP.

Monday, October 18, 2:15 - 3:00pm

SOFTWARE DEMONSTRATION

To Survey or Not to Survey...Online, Paper or Both?

Track: Institutional Research

Primary Presenter: Denis Pantle, *Pearson NCS*

Facilitator: John Kalb, *Southern Methodist University*

Location: Bay 6

Institutional Research requires patience, persistence and Pearson NCS. We can offer a host of solutions that will assist you in your research projects no matter what the size. Our survey products and services allow you to design, administer and deploy surveys for research projects, alumni surveys, course evaluations, and a multitude of other applications. Survey Tracker v 4.0 allows for multiple methods of delivery, such as scannable form, email, or web. Survey Tracker has the ability to provide standard reports, while at the same time is versatile enough to allow you to export the information into statistical analysis packages.

Monday, October 18, 2:15 - 3:00pm

PAPER

Using Markov Chain Models to Project University and Program Level Enrollment

Track: Planning

Primary Presenter: Robert L. Armacost, *University of Central Florida*

Additional Presenter: Alicia L. Wilson, *Walt Disney World Industrial Engineering*

Facilitator: Ruth Salter, *Valdosta State University*

Location: Ocean Springs

In this environment of change and accountability, more effective enrollment projection models are needed. The purpose of this paper is to describe a Markov chain approach to predicting university and program-level enrollment. The Markov chain

methodology will be discussed as well as its application to a metropolitan research university. The accuracy of the university-level projections as well as how it compares to the current enrollment model will be reviewed. Further, preliminary results of a program-level model will be shown. The type and amount of data needed and use of Access and Excel to implement the model will be discussed.

Monday, October 18, 2:15 - 3:00pm
SOFTWARE DEMONSTRATION

Web-Based Unit Planning & Assessment

Track: Planning

Primary Presenter: Beth Patrick, *Morehead State University*

Additional Presenters: Andrea Cornett, *Morehead State University*; Sheri White, *Morehead State University*

Facilitator: Vinay Ramachandra, *Southeastern Louisiana University*

Location: Bay 8

This presentation will demonstrate our web-based unit planning and assessment system. The traditional paper method was resulting in inconsistencies in format and in problems with reporting and data analysis. The web-based system necessitates a consistent format for data entry and provides the ability for unit heads to do ad-hoc reporting and analysis on their unit plan and assessments. In addition, up-line supervisors have inquiry access to their areas unit plans, via the web, prior to and after final submission to the Planning Office

Monday, October 18, 2:15 - 3:00pm
PANEL

Issues and Perspectives in Implementing a Web Based Reporting System and Data Warehouse

Track: Technology

Primary Presenter: Cheryl Tarter, *University of Georgia*

Additional Presenters: Meihua Zhai, *George Mason University*; Sara May, *Mercer University*

Facilitator: Lisa Lord, *Delta State University*

Location: Bay 7

The major issues and perspectives three institutions faced in the implementation of their online reporting systems and the decisions that have proved successful as well as those that were unsuccessful will be discussed. This session will be helpful to anyone embarking on a web based reporting system and will help guide participants in accomplishing their goals. Panelists will explain the process they went through in selecting their software/hardware, data structure, and reporting tools and explain the pros and cons of their choices. Participants are encouraged to bring up any particular issues they are dealing with on their campus.

CONCURRENT SESSIONS

Monday, October 18, 3:30 - 4:15pm
PAPER

An Approach to Integration of Planning and Budgeting

Track: Accreditation

Primary Presenter: Caula A. Beyl, *Alabama A&M University*

Facilitator: Christine L. Mee, *Coastal Carolina University*

Location: Bay 4

SACS criteria for reaffirmation of accreditation maintain that an institution must prepare an appropriately detailed annual budget and that its preparation and execution must be preceded by sound educational planning. In its review of the budget planning process, Alabama A&M University adopted a new system to forge stronger links between the planning process and budgeting using an on-line tool. AAMU has also shifted from organizational unit based planning and reporting to budgetary unit based planning and reporting. Use of this new approach to linking planning and budgeting directly will result in better tracking of unit performance in relationship to university strategic and quality enhancement plans and provides better documentation of annual planning, assessment, and budgeting for SACS.

Monday, October 18, 3:30 - 4:15pm
PAPER

Involving Faculty (and the whole campus) in Assessment for Institutional Improvement

Track: Assessment

Primary Presenter: Randy L. Swing, *Policy Center on the First Year of College*

Facilitator: Martha Lou Byrd, *Pearl River Community College*

Location: Bay 2

It is commonly said that “faculty are resistant” to assessment efforts in higher education. Like many stereotypes, there may be a bit of truth in the statement along with a great deal of exaggeration. The Policy Center on the First Year of College has found high levels of faculty and staff engagement in evaluating the first year of college using an aspirational and measurement model which combines national efforts and local campus task forces. This model, Foundations of Excellence™, combines professional development and multi-dimensional assessment efforts to evaluate a campus’ achievement of excellence as defined by peer institutions. This presentation will explore how faculty professional judgment and creativity have been harnessed in a unique model of institutional assessment for improvement.

Monday, October 18, 3:00—3:30pm

REFRESHMENT BREAK WITH VENDORS

Location: Convention Center Lobby

Sponsored by: “A Friend of MAIR and SAIR” and RTI International.

Monday, October 18, 3:30 - 4:15pm

PAPER

Review and Results: An Example of a Useful Review of an Effectiveness Program at a State University

Track: Assessment

Primary Presenter: Charles Hawkins, *North Georgia College & State University*

Additional Presenters: Jocelyn Clark, *Southern Polytechnic State University*; Henry Codjoe, *Dalton State College*

Facilitator: Mary Beth Adams, *University of Alabama at Birmingham*

Location: Pascagoula

The review of the institutional research and effectiveness program at a small state college is described both from the perspective of the reviewers (two IR directors from other institutions) but also from the perspective of the IR director whose office was being reviewed at his president's request. Findings and use of those findings the following year are detailed along with suggestions for improving such a review.

Monday, October 18, 3:30 - 4:15pm

PANEL

Survey of Organizational Excellence (SOE): its use to improve organizational effectiveness.

Track: Assessment

Primary Presenter: Susan R. Griffith, *The University of Texas-Pan American*

Additional Presenter: Sukhjot Sethi, *The University of Texas-Pan American*

Facilitator: Christian Pruett, *Mississippi Institutions of Higher Learning*

Location: Bay 3

The Survey of Organizational Excellence (SOE), part of a Texas effort to measure the organizational effectiveness and workforce quality of all state agencies, allows an organization's leaders to understand employee perceptions about how well they serve their constituents and how satisfied they are with their employment. This presentation looks at the steps taken by this institution's officials to follow-up on the results of the SOE. It reviews the formation of a task force, its recommendations based on SOE results and implementation of those recommendations for improvement in the functioning of this institution.

Monday, October 18, 3:30 - 4:15pm

PAPER

Institutional Effectiveness Reviews in the Community College: Programs, Disciplines, Services, and Continuing Education

Track: Community College

Primary Presenter: Karen C. Laljiani, *El Centro College*

Facilitator: Harriott D. Calhoun, *Jefferson State Community College*

Location: Ocean Springs

A previous program/discipline review model had been developed during a time of financial crisis and was used to make

some hard decisions. While the process was 'successful,' in that the college was restored to financial health, it left a bad impression upon the college community about the purpose and process of program review. When the vice president for instruction, who had been leading the initiative, left the college for a presidency up north, the system faltered and eventually died. The challenge for our college was to build a new process which would be formative rather than summative in nature, so that it could be used for continuous quality improvement. The new system ties in more closely with college planning and budgeting. It consists of grass roots, bottom-up self-evaluation, which was essential in order for trust to be restored to the process. The system is now in its second year. This session will describe the new model, and share some of the successes and challenges that we encountered during the design and implementation of this new process.

Monday, October 18, 3:30 - 4:15pm

PANEL

Lessons From SAIR History: What Have We Learned?

Track: Institutional Research

Primary Presenter: Larry Jones, *University of Georgia*

Additional Presenters: Members of the SAIR Committee on Mission and Goals

Facilitator: Sarah C. Latham, *Samford University*

Location: Ballroom D

Birthdays and anniversaries are always times for reflection. In this case, the reflection will be on SAIR and on institutional research. The panelists, all seasoned SAIR members, will share what they consider to be the "lessons" learned from SAIR and institutional research that should not be forgotten. Based on what has been learned about institutional research in the last 30 - 40 years, the panel will offer some suggestions about what lessons might have to be learned if SAIR and institutional research are going to last another three or four generations.

Monday, October 18, 3:30 - 4:15pm

CORPORATE DEMONSTRATION

National Student Clearinghouse – Enrollment Search Service

Track: Institutional Research

Primary Presenter: Jim Bundy, *National Student Clearinghouse*

Facilitator: Elaine Turner, *Mississippi State University*

Location: Bay 7

The Clearinghouse, a non-profit corporation established in 1993 to assist schools in reporting student enrollment status, has developed a database that contains the enrollment records of all students enrolled at over 2,700 colleges and universities. The database represents approximately 91% of the currently enrolled students in the United States. Institutional researchers can use the 60+ million student record database from the Clearinghouse to identify enrollment patterns as students migrate from school to school and to identify or confirm a student's enrollment at other institutions before, during and subsequent to the student's attendance at your school.

Monday, October 18, 3:30 - 4:15pm

PAPER

Benchmarking Instructional Activity at Two-Year and Four-Year Colleges and Universities: The Delaware and Kansas Studies of Instructional Costs and Productivity

Track: Planning

Primary Presenter: Michael Middaugh, *University of Delaware*

Additional Presenter: Jeffrey A. Seybert, *Johnson County Community College*

Facilitator: Gregory Gilbert, *Clemson University*

Location: Bay 6

Over the past decade, the Delaware Study of Instructional Costs and Productivity has evolved as the tool of choice for benchmarking faculty teaching loads, instructional costs, and externally funded scholarship, all at the academic discipline level of analysis. However, participation in the Delaware Study is restricted to four-year institutions. The Kansas Study replicates the Delaware Study for use at two-year institutions, using modifications that address the unique community college mission. This session will describe both the initiation of the Kansas Study, and the further evolution of the Delaware Study as a more complete tool for describing faculty activity.

Monday, October 18, 3:30 - 4:15pm

PAPER

Strategic Planning: Institutional Research's Potential

Track: Planning

Primary Presenter: Alan Cox, *The Planning Edge*

Facilitator: Sandi Bramblett, *Georgia Institute of Technology*

Location: Bay 5

Effective strategic planning requires a comprehensive situation analysis of your institution's past, present, and future world. Such an analysis provides a basis for intelligent conversations that can focus on "what the institution must do" to achieve its vision. The situation analysis needs qualitative information from key stakeholders, quantitative information from existing sources, and usually new research as well. Institutional Research can play a vital role in each of these areas. This presentation will discuss how Institutional Research has been used and how it might contribute even more, in strategic planning efforts.

Monday, October 18, 3:30 - 4:15pm

SOFTWARE DEMONSTRATION

AGB Benchmarking Service Demonstration

Track: Technology

Primary Presenter: Merrill Schwartz, *Association of Governing Boards of Universities and Colleges*

Additional Presenter: William R. Fendley, Jr., *Wayne State University*

Facilitator: Glenn James, *Tennessee Technological University*

Location: Bay 8

This new web-based service provides online, customized, benchmarking information using IPEDS and other selected data for multiple years for self-selected peer institutions. Users can generate a variety of graphic reports and easily copy them into

Excel, PowerPoint, or other applications. The variables and ratios features in prepared quick reports and interactive tools address the information needs of senior administrators and boards. These features highlight "big picture" financial and operational indicators that have the greatest relevance for mission and strategy. It is particularly valuable to institutions with limited IR staff, though the ease of use and low cost may appeal to a broad higher education audience.

AFFILIATED AND SPECIAL INTEREST GROUPS

Monday, October 18, 4:30—5:15pm

Alabama Association for Institutional Research (ALAIR)

Convener: Kris Reed Mascetti, *Auburn University Montgomery*

Location: Bay 7

Arkansas Association for Institutional Research (AIRO)

Convener: Diane Atchison, *Southern Arkansas University Tech*

Location: Bay 4

Florida Association for Institutional Research (FAIR)

Convener: Paula S. Krist, *University of Central Florida*

Location: Bay 3

Georgia Association for Institutional Research, Planning, Assessment, and Quality (GAIRPAG)

Convener: Sandra Kinney, *Georgia Department of Technical and Adult Education*

Location: Bay 2

Cooperative Institutional Research Program (CIRP)

Convener: Kit Mahoney, *Higher Education Research Institute, UCLA*

Location: Bay 6

Delaware Study Participants

Convener: Michael Middaugh, *University of Delaware*

Location: Bay 5

Higher Education Data Sharing ((HEDS) Consortium

Convener: Sandy Atkins, *HEDS*

Location: Bay 8

Southeastern Association for Community College Research (SACCR)

Convener: Edie Carter, *Radford University*

Location: Pascagoula

Traditionally Black Colleges and Universities (TBCU)

Convener: Dorothy Cheagle, *Morris College*

Location: Ballroom D

Monday, October 18, 6:00—11:00pm

SPECIAL EVENT

Sunset Cruise and Dinner Dance

Meet in Convention Center Lobby at 5:45pm to walk to boat. Dinner Dance begins at 7:00pm in Ballroom B/C.

Sponsored by: Mississippi Association for Institutional Research (MAIR) and SAS Institute, Inc.

TUESDAY, OCTOBER 19

Tuesday, October 19, 7:30—9:00am

AWARDS BREAKFAST AND BUSINESS MEETING

Convener: Jim Purcell, *Oklahoma State Regents for Higher Education*

Location: Ballroom B/C

Sponsored by: HigherEd.org, SCANTRON and UCLA Higher Education Research Institute (HERI)

CONCURRENT SESSIONS

Tuesday, October 19, 9:15 - 10:00am

PAPER

A Three-Dimensional Approach to Survey Analysis: Adding Value by Adding Three Types of Comparisons

Track: Assessment

Primary Presenter: Mary M. Sapp, *University of Miami*

Facilitator: Bobby Sharp, *Appalachian State University*

Location: Bay 5

Surveys, especially of graduating seniors, are an important assessment tool. This presentation will demonstrate how results from student surveys can be improved by looking at responses along three dimensions: 1) comparisons with peers, 2) trends over time, and 3) breakdowns by demographics. In the tradition of some current reality shows, the session will provide a presentation “makeover,” using sample before and after graphs and tables from a graduating senior survey. The presenter will also share lessons learned about improving presentation effectiveness relating to content, type of presentation, display, order, and customization.

Tuesday, October 19, 9:15 - 10:00am

PAPER

Students' Level of Satisfaction with Early College Life Experiences and Perception of Academic Growth and Preparation

Track: Assessment

Primary Presenter: A. M. Srikanta Rao, *Tuskegee University*

Additional Presenter: W. L. Lester, *Tuskegee University*

Facilitator: Cara Mia Pugh, *Auburn University*

Location: Ocean Springs

Transition from high school to college is challenging and at times traumatic for most freshman students. Before being fully integrated into campus life, they go through a period of anxiety and uncertainty, seeking information and guidance, completing formalities, and making new adjustment to college life. Students' satisfaction or dissatisfaction with experiences encountered on campus is one measure of their adjustment to college life. In this session, results of a study on students' satisfaction or dissatisfaction with campus experiences during the first two years and how these experiences are related to their intellectual, personal and social growth will be discussed.

Tuesday, October 19, 9:15 - 10:00am

PAPER

A New Community College's Effects on a Four-Year Institution

Track: Institutional Research

Primary Presenter: Kenneth A. Smith, *Southeastern Louisiana University*

Facilitator: Darla Keel, *University of Memphis*

Location: Bay 2

The Community College system is relatively new to the state of Louisiana, with the Louisiana Community and Technical College System Board of Supervisors becoming operational on July 1, 1999. This system oversees three long-established community colleges previously governed by the University of Louisiana System, along with four relatively new community colleges. This paper will examine the effects on a four-year institution when a new community college is created in its market area.

Tuesday, October 19, 9:15 - 10:00am

PAPER

Faculty Perceptions of Institutional Research

Track: Institutional Research

Primary Presenter: Fletcher F. Carter, *Radford University*

Facilitator: Dave Mullins, *East Mississippi Community College*

Location: Bay 4

Since their establishment in the 1960's, institutional research offices have nearly always been predicated upon service to the decision-makers of institutions of higher education. A few offices have attempted to provide services to faculty and other personnel. A search of the literature provides few examples of faculty perceptions of the services of institutional research. In most cases, these examples are only ratings of services. This paper will survey faculties of several Virginia colleges and universities on their perceptions of faculty service by institutional researchers and methods of improving these services.

Tuesday, October 19, 9:15 - 10:00am

PAPER

Tracking Student Performance in DSP and College-Level Math and English Courses

Track: Institutional Research

Primary Presenter: Diby Kouadio, *Columbia State Community College*

Facilitator: Debbie Dailey, *Georgetown University*

Location: Bay 3

This paper involves tracking the academic progress of students enrolling at Columbia State Community College, from the developmental studies program through the first level of college Math and English courses. This research presents a factual analysis of the academic progress Columbia State students have made in preparing for college-level courses. Overall, the results indicate that a small proportion of students enrolling in DSP courses subsequently enroll in and pass college courses. Of the students passing college courses, a few first placed in develop-

mental studies courses as most students could directly enroll in college courses. It was also found that when students have the required competence and place in more challenging DSP or college course

Tuesday, October 19, 9:15 - 10:00am
SOFTWARE DEMONSTRATION

Dynamic Web-Based Department Profiles Using ASP & Other New Technologies

Track: Technology
 Primary Presenter: Denise S. Gater, *University of Florida*
 Additional Presenter: Will Collante, *University of Florida*
 Facilitator: Lorne Kuffel, *College of William and Mary*
 Location: Bay 7

This presentation will demonstrate the use of Microsoft’s Active Server Pages (ASP) and other new technologies to deliver dynamic, Web-based data in an interactive format to campus users. Presenters will address the relative strengths, weaknesses, and special features of the technologies utilized. The Department Profiles Website developed by the university’s Office of Institutional Research illustrates the benefits of this approach versus delivery of data in static web pages. This system now provides campus administrators a quick, easy, and timely academic and financial profile of colleges, departments, and units based on multiple years of official university data.

Tuesday, October 19, 9:15 - 10:00am
PAPER

The Power of Excel Pivot Tables

Track: Technology
 Primary Presenter: Mary Harrington, *University of Mississippi*
 Facilitator: Marcus Babayo, *Worcester State College*
 Location: Bay 6

Excel pivot tables can transform cumbersome spreadsheet data into meaningful tables, charts and graphs almost effortlessly. This presentation will provide an introduction to Excel pivot tables, and illustrate their usefulness in an Institutional Research office. A demonstration of the steps to build a simple pivot table will provide the framework for the introduction of more advanced features. A step-by-step guide, along with live demonstrations, will enable attendees to easily create multi-dimensional analyses of Excel data in their own environment.

Tuesday, October 19, 9:15 - 10:00am
PANEL

IPEDS Executive Peer Tool (ExPT) and Other New Tools for Institutional Researchers

Track: Technology
 Primary Presenter: John Milam, *HigherEd.org, Inc*
 Additional Presenters: Janice A. Plotczyk, *National Center for Education Statistics*; Susan G. Broyles, *National Center for Education Statistics*
 Facilitator: Roy D. Ikenberry, *Belmont University*
 Location: Bay 8

Panelists will demonstrate the use of the IPEDS Executive Peer

Tool (ExPT), which has the same general interface and “look and feel” as the Peer Analysis System. The ExPT uses a simple, 4-step process that allows novices to duplicate or customize the results of the NPEC Data Feedback Reports. Peer Analysis System: Panelists will demonstrate the use of newly available “frequently used variables” and “derived variables” and the new navigation in the Peer Analysis System. Several new design concepts have been implemented that make using the peer tool easier than ever before. Dataset Cutting Tool: Attendees will see a demonstration of the Dataset Cutting Tool that allows users to make customized data files and to download entire IPEDS data files.

10:15—11:00am CONCURRENT SESSIONS

Tuesday, October 19, 10:15 - 11:00am
PAPER

Improving Student Retention and Graduation Rates: A Case Study From a Senior Public University

Track: Assessment
 Primary Presenter: Mary Gunn, *Coastal Carolina University*
 Additional Presenter: Christine L. Mee, *Coastal Carolina University*
 Facilitator: Sandi Bramblett, *Georgia Institute of Technology*
 Location: Bay 6

A senior public university has made student retention its number one priority. In response to this, the university’s Office of Institutional Research and Assessment approached the Provost with an idea: Convene a committee on student retention and graduation, develop a plan for identifying those variables that impact student retention, and recommend possible intervention strategies. In this work-in-progress case study, we describe the steps that we are taking at our university to address student retention and provide suggestions for actions to embrace and to avoid.

Tuesday, October 19, 10:15 - 11:00am
PAPER

Is It Working?—Assessing an Institution’s Program Assessment Process

Track: Assessment
 Primary Presenter: Robert Armacost, *University of Central Florida*
 Additional Presenter: Julia Pet-Armacost, *University of Central Florida*
 Facilitator: Michel Schexnayder, *Louisiana State University*
 Location: Bay 2

Program assessment, a major component of an institutional effectiveness process, has become a central component of an institution’s accreditation. The increased role of program assessment to identify opportunities for improving student learning outcomes is a critical management tool in higher education. In response to this need, institutions have developed a number of different approaches to implement program assessment. This presentation develops an approach that can be used to assess

how well an assessment process is functioning and whether the implementation of the process has the capability of effectively assessing student learning and other program outcomes.

Tuesday, October 19, 10:15 - 11:00am

PAPER

The Dependability of NSSE “Scalelets” for College- and Department-Level Assessment

Track: Assessment

Primary Presenter: Gary Pike, *Mississippi State University*

Facilitator: Stephanie Thompson, *University of Memphis*

Location: Bay 3

Faculty members are more likely to take responsibility for student learning if they believe that the assessment data represent their students and suggest specific actions for improvement. This study examined whether it is feasible to develop “scalelets” (i.e., focused measures, usually consisting of four or five items) that provide dependable metrics for assessing student learning at the college or department level. A generalizability analysis of 12 scalelets from the NSSE survey indicated that the scalelets provided dependable measures of educational effectiveness with 25-50 or more respondents.

Tuesday, October 19, 10:15 - 11:00am

PAPER

Weathering the Storm: Challenges of the Future for Community Colleges

Track: Community College

Primary Presenter: Edie Carter, *Radford University*

Facilitator: Mary Hankins, *Delta State University*

Location: Ballroom D

For Community Colleges these are trying times: Enrollments are up and state financial support is down. Community Colleges are faced with monumental challenges. How these challenges are met may shape institutions for years to come. As economic conditions worsen, it is time to think how we do business and to emerge from this period stronger and more competitive. The purpose of this presentation will be to explore how community colleges are responding to a changing environment and what Institutional Research and Planning can do to prepare colleges for an increasingly competitive society.

Tuesday, October 19, 10:15 - 11:00am

PAPER

Measuring Faculty Work: An Interactive Approach

Track: Institutional Research

Primary Presenter: Ruth Salter, *Valdosta State University*

Facilitator: Gerry Dizinno, *St. Mary's University*

Location: Bay 5

This presentation describes the interactive multifaceted approach undertaken by one mid-sized university to measure and communicate faculty workload evaluation. The presentation will discuss an on-going process for measuring faculty productivity that involves all levels of the university including faculty, department chairs, administrators, and institutional researchers in concert with a comprehensive strategic planning process. The

presenter will discuss benchmarking through the Delaware Study of Faculty Cost and Productivity as part of an interactive approach for evaluating faculty load, communicating results, and informing action.

Tuesday, October 19, 10:15 - 11:00am

PAPER

Faculty Use of Course Management Systems (CMS) Within the University of System of Georgia

Track: Planning

Primary Presenter: H. Hilliard Gastfriend, *University System of Georgia*

Additional Presenter: Catherine Finnegan, *University System of Georgia*

Facilitator: Larry Jones, *The University of Georgia*

Location: Ocean Springs

Increasingly colleges, universities, and higher-education systems have begun exploring and implementing enterprise-wide computer software solutions to handle the massive data build-up modern campuses generate in registration, disbursements, online instruction, and other educational and administrative systems. This presentation describes preliminary results of a system-wide survey of faculty in their use of (or lack of use of) online course management systems.

Tuesday, October 19, 10:15 - 11:00am

PAPER

IR Support for Strategic Planning of Study Abroad Programs: Building the Framework

Track: Planning

Primary Presenter: R. Jayne Perkins, *Georgia Southern University*

Additional Presenter: Marsha R. Allen, *University of Georgia*

Facilitator: Jana Marak, *Baylor University*

Location: Pascagoula

The development of Study Abroad Programs must be linked to institutional strategic planning for proper funding and support for services. Such links can best be identified through partnerships within the institutional organization, such as institutional research and academic units. The breadth of knowledge of institutional researchers can offer unique insights to program development needs that may not be realized from the academic unit perspective alone. This paper seeks to share how Georgia institutions are bridging the gap between planning and development of Study Abroad Program areas.

Tuesday, October 19, 10:15 - 11:00am

SOFTWARE DEMONSTRATION

Demystifying the Extensible Markup Language

Track: Technology

Primary Presenter: Nick Roberts, *Kennesaw State University*

Additional Presenter: James Few, *Kennesaw State University*

Facilitator: Pat Dewitt, *Shorter College*

Location: Bay 7

The utilization of the Internet as an information delivery medium has been of great value to institutional research offices in

the past several years. A new technology has surfaced that promises to make life easier for both technical and non-technical institutional research professionals: the Extensible Markup Language (XML). As pervasive as XML has become in the information technology industry, it remains a source of confusion for many people. This presentation aims to clear the mysteries surrounding XML by showing why people should care, what they should know, and how they can use XML in their business processes.

Tuesday, October 19, 10:15 - 11:00am

SOFTWARE DEMONSTRATION

Student Engager – Graduate Research Management Process

Track: Technology

Primary Presenter: Razzakul H. Chowdhury, *Jackson State University*

Additional Presenter: James S. Maddirala, *Jackson State University*

Facilitator: Susan Griffith, *The University of Texas – Pan American*

Location: Bay 4

Student Engager is a versatile tool for students to conduct graduate research individually and collaboratively using the Knowledge Management software Quantum. The Quantum software platform is designed to connect information, people, and resources within a department or between departments through a multifaceted metadata layer that is transparent to the users. Students and their Advisors could interact among themselves, exchange ideas, and enhance knowledge in a collaborative fashion. Quantum enables the on-demand delivery of relevant information that considers both the semantic value of content and information and the social activity around it within its organizational context.

11:15am—Noon CONCURRENT SESSIONS

Tuesday, October 19, 11:15am - Noon

PAPER

Equal Pay for Equal Work? Conducting a Faculty Salary Study at a University

Track: Assessment

Primary Presenter: Sarah Latham, *Samford University*

Additional Presenter: Karen Hamby, *Samford University*

Facilitator: Nerissa Rivera, *Duke University*

Location: Ballroom D

Faculty salaries and questions of equity continue to be a hotly debated items in academe. Understanding faculty salary trends and distributions is important to multiple stakeholders. The ability to conduct salary studies in an objective environment is crucial to findings that are valid, reliable, and useful. Thus, Institutional Research Offices should serve central roles in such assessment. This presentation looks at the effort of one institution to incorporate faculty salary into its annual assessment measures. The presenters will take participants through every

step in conducting such a study, from gaining buy-in to following up on the institution’s salary progress.

Tuesday, October 19, 11:15am - Noon

PAPER

Teacher Education Program Assessment Plan – A Small College’s Approach To Assessment

Track: Assessment

Primary Presenter: Michael Hadley, *Methodist College*

Additional Presenter: Dan "Dana" Xiao, *Methodist College*

Facilitator: Renee Hicks, *Nicholls State University*

Location: Bay 2

This paper is a case study of effective assessment practices. The focus of the case study will be the development and implementation of an assessment plan for the Teacher Education Program at a small college. The study will examine the various assessment strategies that are available, how to incorporate multiple methods of assessment, deciding what data to collect, and how to utilize that data to improve the quality of academic programs.

Tuesday, October 19, 11:15am - Noon

PAPER

The Effect of Deferred Greek Participation on Academic Performance

Track: Assessment

Primary Presenter: Larry Mayes, *University of North Carolina at Chapel Hill*

Additional Presenter: Lynn Williford, *University of North Carolina at Chapel Hill*

Facilitator: Jim Hood, *Mississippi Institutions of Higher Learning*

Location: Ocean Springs

The purpose of this study is to assess the effect on actual and perceived academic performance as a result of deferring sorority or fraternity membership from the freshman to sophomore academic year. Also explored will be the relationship between Greek membership and students’ engagement in educationally effective practices and their overall satisfaction with college and advanced degree and career aspirations.

Tuesday, October 19, 11:15am - Noon

SOFTWARE DEMONSTRATION

A Web-Based Planning and Program/Service Review Software

Track: Community College

Primary Presenter: Patricia Abell, *Guilford Technical Community College*

Facilitator: René Toups, *University of New Orleans*

Location: Bay 7

GTCC has an integrated planning, program/service review, and budgeting process in place and working well for the past seven years. College goals, strategic initiatives, unit goals, program/service reviews, and assessment guide the development of annual objectives and action plans that include a breakdown of budgetary needs. Web-based software has been used for the

past two years to incorporate it all into an easy-to-complete set of screens. Additionally, the software produces unit/group plan reports, summary reports for the Board of Trustees, and end-of-year status reports. An accepted and working process has been made easier; faculty and staff are happier!

Tuesday, October 19, 11:15am - Noon

SOFTWARE DEMONSTRATION

Accessing and Using the Delaware Study Secure Server to Develop Customized Peer Analyses for Multiple Disciplines at Your Institution

Track: Institutional Research

Primary Presenter: Michael F. Middaugh, *University of Delaware*

Facilitator: Joseph Beatriz, *Georgia Military College*

Location: Bay 8

In 2001, the University of Delaware developed a data set housed on a secure server that enables participants in the Delaware Study to develop customized peer analyses in the same fashion that the University of Delaware's Office of Institutional Research and Planning had done for requestors over the past decade. This demonstration will describe that data set and will provide attendees with the basic tools and skills for developing peer analyses. The intent is to enable institutions with multiple disciplines to develop different peer groups for those disciplines, as appropriate.

Tuesday, October 19, 11:15am - Noon

PAPER

Chicken Soup for the IR Soul: Inspiration for the Year Ahead

Track: Institutional Research

Primary Presenter: Daina P. Henry, *College of William and Mary*

Facilitator: Larry Johnson, *Tougaloo College*

Location: Bay 5

Institutional researchers and planners (and higher education in general) are being asked to do more with less - less money, less staff, and less time. Managing multiple priorities and conflicting crisis are part of the IR daily operations. This paper hopes to provide "chicken soup" for the IR soul. Using Stephen Covey's "7 habits of effective people" as the broth of the soup, adding Carlson's "it's all small stuff" as a starch, and garnishing with the herbs from MacKensie's "orbiting the giant hairball", Breathnach's "simple abundance", Kuhn's "The Structure of Scientific Revolutions" and Tolkien's "speak friend and enter," this paper will hopefully provide nourishment to and a light hearted look at the IR soul.

Tuesday, October 19, 11:15am - Noon

SOFTWARE DEMONSTRATION

SPSS 101: Practical Uses for Institutional Researchers

Track: Institutional Research

Primary Presenter: Dana L. Dalton, *Winston-Salem State University*

Facilitator: Teresa Orok, *Albany State University*

Location: Bay 3

SPSS is a thorough tool for the compilation, analysis and reporting of almost any type of data. This data system allows data file import, template building, formation of data dictionaries and of course, statistical analyses from descriptive to inferential. Once the data is in, tabulations, analyses, charts and reports can be generated directly. SPSS is user friendly for first-timers and allows seasoned veterans to write their own command syntax. SPSS easily copies to other Microsoft Office Products. IR professionals will find SPSS to be an invaluable tool.

Tuesday, October 19, 11:15am - Noon

PAPER

Projecting Undergraduate Enrollment and Net Revenue: An Approach to Determining Financial Need and Student Enrollment in Order to Provide Adequate Resources

Track: Planning

Primary Presenter: John Kalb, *Southern Methodist University*

Additional Presenter: Randall Powell, *Southern Methodist University*

Facilitator: Denise Gardner, *Georgia Institute of Technology*

Location: Bay 6

It is imperative that schools have adequate resources. When the primary source of revenue is the undergraduate enrollment, there must be a methodology in place to accurately predict/estimate the optimum entering student population. It is essential to predict not only the size of the incoming class of the First-Time-in-College students, but also the Transfers, and the resulting future class sizes which are dependent on each year's matriculants. This paper presents a methodology used to create a net revenue model using financial aid expenditures and enrollment objectives.

Tuesday, October 19, 11:15am - Noon

CORPORATE DEMONSTRATION

Data Mining Using SAS Enterprise Miner

Track: Technology

Primary Presenter: James C. Ford, *SAS*

Facilitator: Teresa Hall, *University of Alabama at Birmingham*

Location: Bay 4

Data mining can be defined as advanced methods for exploring and modeling relationships in large amounts of data. Data mining has been used by universities in a number of areas, including but not limited to enrollment management, retention and graduation analysis, and donation prediction. This presentation will give you an overview of the data mining process and will introduce Enterprise Miner - the SAS solution for data mining. It will give details on the capabilities of Enterprise Miner as well as a demonstration of the tool.

Tuesday, October 19, 11:15am - Noon

PAPER

Using CAPS to Influence Computing Performance and Perceptions

Track: Technology

Primary Presenter: Cynthia Y. Lester, *The University of Alabama*

Facilitator: Rosella L. Houston, *Jackson State University*

Location: Pascagoula

Technology is an integral part of everyday life. At school, home, or work, people use computers. Consequently, there is an increased demand for people to possess computer skills. However, studies show that fewer women are earning degrees and receiving training in technology-related disciplines than did 20 years ago. While there are suggested reasons for the gender gap, women's perceptions about their computing capabilities are worth exploring. The research explores how educational training software and a computer assisted peer-modeling software application, CAPS, can be used to influence females' level of computer self-efficacy and performance and hence affect their perceptions on computing.

Tuesday, October 19, 12:15—3:00pm

SAIR BOARD MEETING

Convener: Ross Griffith, *Wake Forest University*

Location: D'Iberville

SAIR 2005 Charleston, South Carolina



We will be in Charleston, South Carolina, October 22 - 25, 2005 at the Francis Marion Hotel. This hotel was meticulously restored in 1996 with a \$12 million National Trust for Historic Preservation award-winning restoration. The Francis Marion Hotel now combines 1920's style and grace with 21st Century comfort and convenience in the heart of historic Charleston on Marion Square. Rising 12 stories, many of the hotel's guestrooms and suites offer spectacular views of Charleston's historic harbor, church steeples and legendary King Street. Opening this fall is a new state-of-the-art conference facility that will incorporate the most advanced technology with world-class service and historic charm.

Lisa Pace and Pam King from The Citadel and Chris Mee from Coastal Carolina University are undertaking leadership of the local arrangements.

SAIR 2004 VENDORS AND SPONSORS

VENDORS

You are invited to visit the following vendor exhibits and talk with their representatives. Exhibits will be located in the Convention Center Lobby.

Association for Institutional Research (AIR)

Glenn James
Gail Fishman

HigherEd.org

John Milam

National Resource Center for the First-Year Experience and Students

Randy Swing

National Student Clearinghouse

Jim Bundy

Nuventive

Alan Buckner
Denise Raney

Pearson NCS

Denis Pantle

RAND Council for Aid to Education (CAE)

Roger Benjamin
Marc Chun

SAS Institute, Inc.

James C. Ford

SCANTRON

Janet Woo

SPSS, Inc.

Celeste Pechous

UCLA Higher Education Research Institute (HERI)

Kit Mahoney
Jennifer Lindholm
Alyssa Bryant

Visionaire

Levi Bailey

SPONSORS

***Mississippi Gulf Coast Community College
SPSS, Inc.***

Sunday Evening Reception

***National Student Clearinghouse
RTI International***

Monday Continental Breakfast

RTI International

Monday Roundtable Luncheon

“A Friend of MAIR and SAIR”

RTI International

Monday Afternoon Refreshment Break

***Mississippi Association for Institutional
Research (MAIR)***

SAS Institute, Inc.

Monday Evening Special Event

HigherEd.org

SCANTRON

***UCLA Higher Education Research
Institute (HERI)***

Tuesday Morning Awards Breakfast

SAIR 2004 Conference Planning Committees

Program Chair, 2004 SAIR Conference

Ross Griffith, *Wake Forest University*

Conference Steering Committee

Ross Griffith (Chair), *Wake Forest University*
 Joseph Cliburn, *Mississippi Gulf Coast Community College*
 Julie Fulgham, *Mississippi State University*
 Denise Gardner, *Georgia Institute of Technology*
 Michelle Hall, *Southeastern Louisiana University*
 Mary Harrington, *University of Mississippi*
 Joseph Hoey, *Georgia Institute of Technology*
 Lorne Kuffel, *College of William and Mary*
 Christine Mee, *Coastal Carolina University*
 Jim Purcell, *Oklahoma State Regents for Higher Education*

Program Tracks

Jim Eck (**Accreditation**), *Rollins College*
 Cornelia Wills (**Assessment**), *Middle Tennessee State University*
 Larry Gracie (**Community Colleges**), *North Carolina Community College System*
 Larry Jones (**Institutional Research**), *Institute for Higher Education, University of Georgia*
 Sandi Bramlett (**Planning**), *Georgia Institute of Technology*
 John Milam (**Technology**), *HigherEd.org, Inc.*

Local Arrangements

Joseph Cliburn (Co-Chair), *Mississippi Gulf Coast Community College*
 Julie Fulgham (Co-Chair), *Mississippi State University*
 Gwen Aldridge, *Northwest Mississippi Community College*
 Johanna Bettis, *Mississippi State University*
 Jan Reid-Bunch, *Itawamba Community College*
 Cathy Ellett, *Copiah-Lincoln Community College*
 Margie Hobbs, *University of Mississippi*
 Jim Hood, *Mississippi Institutions of Higher Learning*
 Kathy Huffman, *Mississippi State University*
 Mary Harrington, *University of Mississippi*
 Mitzy Johnson, *Northeast Mississippi Community College*
 Lisa Lord, *Delta State University*
 David Mullins, *East Mississippi Community College*
 Steve Okoye, *Jackson State University*
 Cassandra Sessoms, *Mississippi College*
 Elaine Turner, *Mississippi State University*

Workshops

Denise Gardner (Chair), *Georgia Institute of Technology*
 Joseph Cliburn, *Mississippi Gulf Coast Community College*
 Mitzy Johnson, *Northeast Mississippi Community College*

Papers, Panels and Software Demonstrations

Rob Springer (Chair), *Elon University*
 Joachim Knop, *George Washington University*
 Mary Korfhage, *University of Louisville*
 Andrew Luna, *State University of West Georgia*
 Janice Schaeffler, *Radford University*

Roundtables

Mary Harrington (Co-Chair), *University of Mississippi*
 Margie Hobbs (Co-Chair), *University of Mississippi*

Speakers

Ross Griffith (Co-Chair), *Wake Forest University*
 Julie Fulgham (Co-Chair), *Mississippi State University*

Registration and Help Desk

Michelle Hall (SAIR Treasurer), *Southeastern Louisiana University*
 Annette Accomando, *Nunez Community College*
 Donald Boeckman, *Southeastern Louisiana University*
 Katie Duplantis, *Nicholls State University*
 Renee Hicks, *Nicholls State University*

Jacob Jasin, *Southeastern Louisiana University*
 Treva Lee, *Xavier University of Louisiana*
 Barbara Poole, *Bossier Parish Community College*
 Vinay Ramachandra, *Southeastern Louisiana University*
 René Toups, *University of New Orleans*
 Jennifer Videtto, *Northwestern State University*

Conference Tours

Margie Hobbs, *University of Mississippi*

Photography

Heidi Jordan, *Coastal Carolina University*

Awards

Marcus Babaoye (Chair), *Worcester State College*
 Teresa Hall, *University of Alabama at Birmingham*

Newcomers

Christine Mee (Chair), *Coastal Carolina University*
 Lorne Kuffel, *College of William and Mary*
 Kendrick Tatum, *Duke University*
 Catherine Watt, *Clemson University*

Special Interest Groups

Donald Cunningham, *University of Tennessee*

Facilitators

Jan Reid-Bunch (Chair), *Itawamba Community College*
 Lisa Lord, *Delta State University*

Special Event

Mary Harrington (Chair), *University of Mississippi*
 Joseph Cliburn, *Mississippi Gulf Coast Community College*
 Julie Fulgham, *Mississippi State University*

Travel Grants

Christine Mee (Chair), *Coastal Carolina University*
 Teresa Hall, *University of Alabama at Birmingham*

Sponsors and Exhibits

Lorne Kuffel (Chair), *College of William and Mary*
 Michelle Hall, *Southeastern Louisiana University*
 Valerie Paton, *Texas Tech University*
 Roy Philbrook, *Schreiner University*

Equipment and Technical Support

Joe Cliburn (Co-Chair), *Mississippi Gulf Coast Community College*
 Mitzy Johnson (Co-Chair), *Northeast Mississippi Community College*
 Donald Boeckman, *Southeastern Louisiana University*
 Mary Harrington, *University of Mississippi*
 Sherry Holt, *Northeast Mississippi Community College*
 Jim Hood, *Mississippi Institutions of Higher Learning*
 Lisa Lord, *Delta State University*
 Steve Okoye, *Jackson State University*
 Christian Pruett, *Mississippi Institutions of Higher Learning*
 Cathy Tanner, *Bishop State Community College*

Conference Website

Adam Shick, *Wake Forest University*
 Christine Mee, *Coastal Carolina University*

Conference Publications/Announcements

Sara Gravitt, *Wake Forest University*
 Larry Jones, *University of Georgia*

Conference Evaluations

Debbie Head, *Kennesaw State University*
 Donna Hutcheson, *Kennesaw State University*
 Erika Newcomer, *Higher Education Data Sharing (HEDS) Consortium*
 Nerissa Rivera, *Duke University*

Bayview Meeting Space

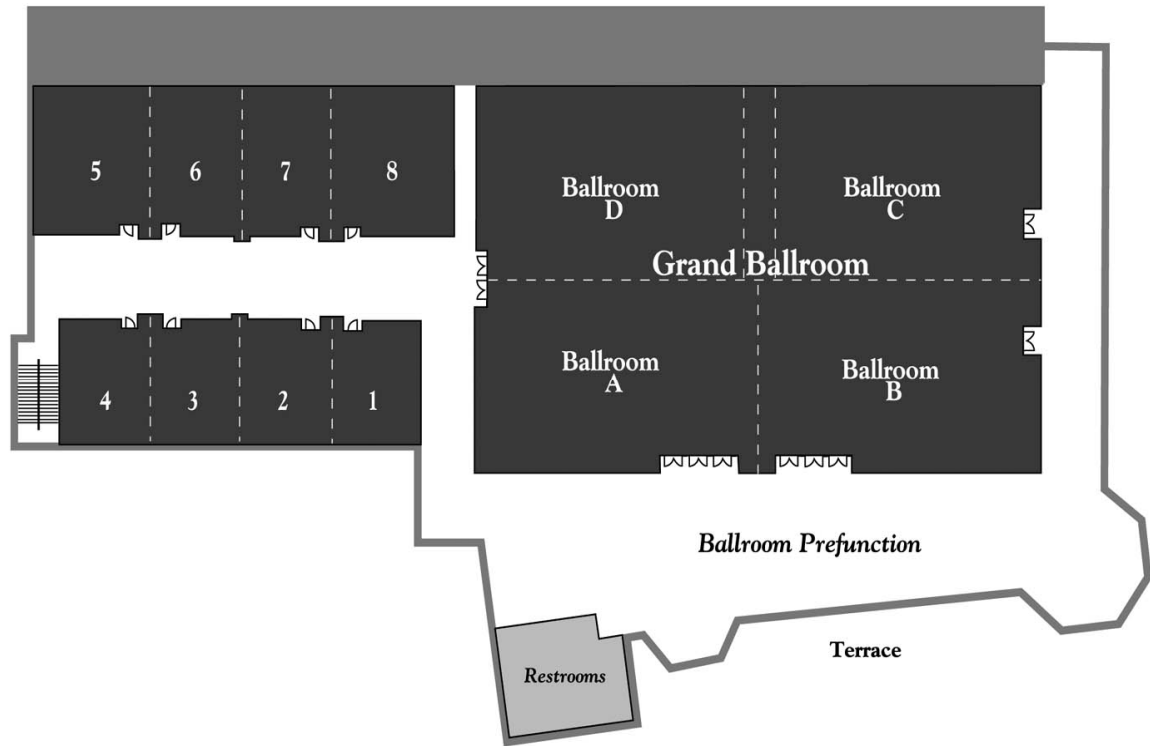

Islandview Meeting Space

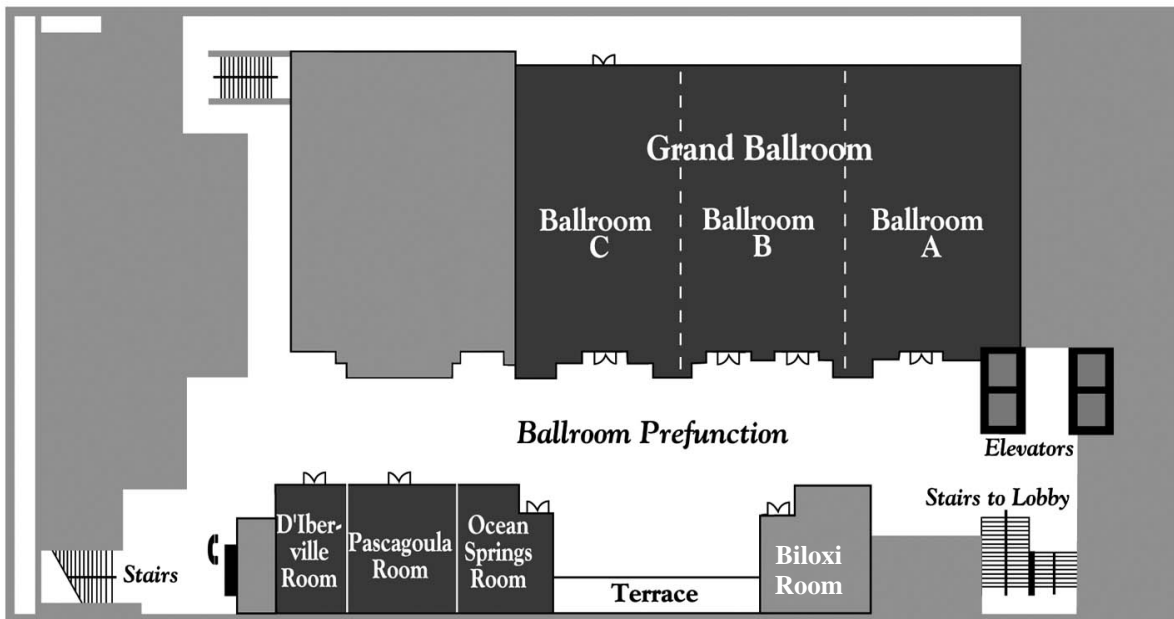



2004